



Date: March 7, 2023

PROJECT: Water Valve & Sanitary Sewer Main Improvements

SUBMITTAL DATE: 2:00 pm on March 14, 2023

ADDENDUM NO. 1: Bid Documents for this project are being modified, supplemented, clarified or augmented as follows as part of this addendum. All revisions will hereby be made a part of the proposed Contract Documents.

The following attachments are issued with this addendum.

Drawings: Reissued drawing pages WL & W9 with clouded and noted changes below.

Specifications: Bid document new pages 3-Add 1, 16-Add 1 thru 19-Add 1, 31-Add 1 thru 37-Add 1, 38-Add 1, 359-Add 1 thru 385-Add 1 and 386-Add 1 thru 397-Add 1 as noted below

<u>MODIFICATION NO.</u>	<u>SUMMARY</u>
-------------------------	----------------

1	<b>REPLACE</b> current Page 3 with the attached <b>REVISED</b> Page 3 – Add 1. Changed dates for work completion on the project as highlighted in gray.
---	---------------------------------------------------------------------------------------------------------------------------------------------------------

2	<b>REPLACE</b> current Bid Proposal Page 16 thru 19 with the attached <b>REVISED</b> Pages 16 - Add 1 thru 19 – Add 1. Changes is highlighted in gray and noted below.
---	------------------------------------------------------------------------------------------------------------------------------------------------------------------------

**Page 16 thru 19 Changes:**

- 1) Added two (2) additional - 10" Insert Valves
- 2) Added requested pricing for Tapping Sleeves for various sizes of pipe. Pricing is requested as these items may be needed during the project.
- 3) Changed wording from "Gate Valve and Box" to "Gate Valve Box Only". Valve pricing is accounted for in other pay items and this was intended for boxes only.

3                   **REPLACE** current “Water Valve Replacement Project Information” Pages 31 thru 37 with the attached **REVISED** Pages 31 - Add 1 thru 37 – Add 1. Changes is highlighted in gray and noted below.

**Page 31 thru 37 Changes:**

- 1) Added Intermediate Completion Date for certain work items within the project.
- 2) Revised the Final Completion Date for the Water Valve Replacement work.
- 3) Updated the Water Valve Replacement Locations table to include the two additional 10” Insert Valves.

4                   **REPLACE** current “Sanitary Sewer Lining and Replacement Project Information” Page 38 with the attached **REVISED** Pages 38 - Add 1. Changes is highlighted in gray and noted below.

**Page 38 Changes:**

- 1) Revised the Final Completion Date for the Sanitary Sewer work.

5                   **REPLACE** current CDBG Specific Documents Wage Rate Decision MI20230001 (2/3/2023) Pages 359 thru 385 with attached **REVISED** Wage Rate Decision MI20230001 (2/17/2023) Pages 359-Add 1 thru 385-Add 1.

6                   **REPLACE** current CDBG Specific Documents Wage Rate Decision MI20230044 (2/3/2023) Pages 386 thru 397 with attached **REVISED** Wage Rate Decision MI20230044 (2/17/2023) Pages 386-Add 1 thru 397-Add 1.

7                   Drawing WL added locations for the 2 additional Insert Valves, clouded.

8                   Drawing W9 added the two insert valves as clouded.

Sanitary Sewer Videos: Should you wish to see the video and reports for the sanitary sewer mains in this project please utilize the following link to our FTP site:

<https://ftp2.hillsdale.us/public/folder/4GYi4YYEsEaDoEg6nP0Yg/Water%20Valve%20%26%20Sanitary%20Sewer%20Improvement%20Project>

Password:  
sewer\_videos\_cdbg\_project

Sincerely,

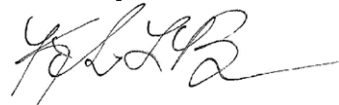

Kristin L. Bauer, P.E.  
City Engineer – 517-437-6479

## **INSTRUCTIONS TO BIDDERS**

The City of Hillsdale Board of Public Utilities (BPU) is requesting proposals for the following project:

The project will address critical infrastructure maintenance/improvements required throughout the City of Hillsdale on the water main and sanitary sewer systems.

Water System: Replacement of water shut off valves in the water main system.

Sanitary Sewer System: Replacement and/or cured-in-place lining of existing sanitary sewer system and construction of a new force main and associated lift station.

### **RFP due date/ Public Opening:**

Sealed proposals are due by 2:00 pm (local time) on March 14, 2023 at the following location:

Hillsdale City Hall  
Office of the City Clerk  
97 N. Broad Street  
Hillsdale, MI 49242

### **Project Locations:**

Water System Work: Locations are throughout the City of Hillsdale. See project drawing "WL" for locations of water valves to be replaced.

Sanitary Sewer System Work: Locations are throughout the City of Hillsdale. See project drawing "SAN L" for locations of sanitary sewer work.

### **Scope of Work:**

This project is a prevailing wage project and subject to Davis-Bacon Wage requirements.

Water System Work: Replacement of water shut off valves in the water main system by direct replacement or utilizing a live tap insert valve. Other miscellaneous items of work will include removal and installation of fire hydrants and relocations water service lines (curb stop to water main).

Sanitary Sewer System Work: Replacement and/or cured-in-place lining of identified sections of the existing sanitary sewer sections and construction of a new sanitary sewer force main and lift station. Other miscellaneous items of work may include reconstruction of existing manholes and/ or construction of new manholes.

All work shall be in accordance with the project drawings, project specifications and any applicable sections of the 2012 MDOT Standard Specifications for Construction.

### **Proposed Project Schedule:**

BPU Board Presentation:	April 11, 2023
City Council Anticipated Award of Contract:	April 17, 2023
Notice to Proceed:	approximately 60 Days following bid receipt and public notice of project.
Early Construction Start Date:	May 15, 2023
<b>Intermediate Water System Work Date:</b>	<b>December 31, 2023</b>
Final Water Valve Replacement Completion Date:	<del>December 31, 2023</del> <b>November 1, 2024</b>
Sanitary Sewer Construction Completion Date:	<del>August 30, 2024</del> <b>November 1, 2024</b>

ITEM DESCRIPTION	EST. QUANT.	UNIT	UNIT COST	TOTAL COST
Tapping Valve, 10"	1	EA		
Tapping Valve, 12"	2	EA		
Tapping Valve, 16"	0	EA		\$ 0.00
Insert Valve, 4"	0	EA		\$ 0.00
Insert Valve, 6"	4	EA		
Insert Valve, 8"	0	EA		\$ 0.00
Insert Valve, 10"	4	EA		
Insert Valve, 12"	1	EA		
Insert Valve, 16"	0	EA		\$ 0.00
Sleeve, 4"	26	EA		
Sleeve, 6"	52	EA		
Sleeve, 8"	10	EA		
Sleeve, 10"	10	EA		
Sleeve, 12"	18	EA		
Sleeve, 16"	0	EA		\$ 0.00
Tapping Sleeve, 4" x 4"	0	EA		\$ 0.00
Tapping Sleeve, 4" x 6"	0	EA		\$ 0.00
Tapping Sleeve, 6" x 6"	0	EA		\$ 0.00
Tapping Sleeve, 6" x 8"	0	EA		\$ 0.00
Tapping Sleeve, 8" x 8"	0	EA		\$ 0.00
Tapping Sleeve, 8" x 10"	0	EA		\$ 0.00
Tapping Sleeve, 10" x 10"	0	EA		\$ 0.00
Tapping Sleeve, 10" x 12"	0	EA		\$ 0.00
Tapping Sleeve, 12" x 12"	0	EA		\$ 0.00
Reducer, 6" to 4"	14	EA		
Reducer, 8" to 6"	3	EA		
Reducer, 10" to 8"	3	EA		
Reducer, 12" to 10"	3	EA		

ITEM DESCRIPTION	EST. QUANT.	UNIT	UNIT COST	TOTAL COST
Pipe Section, C900-DR18, 4"	52	LF		
Pipe Section, C900-DR18, 6"	104	LF		
Pipe Section, C900-DR18, 8"	20	LF		
Pipe Section, C900-DR18, 10"	20	LF		
Pipe Section, C900-DR18, 12"	36	LF		
Pipe Section, C900-DR18, 16"	0	LF		\$ 0.00
Gate Valve Box Only	65	EA		
Curb Stop and Box	5	EA		
Pav't Sawcut – Street Surface	1975	LF		
Valve Replacement Site Work	70	EA		
Overnight/Weekend Replacement Site Work	2	EA		
Water Service, Long, 1 Inch	5	EA		
Water Service Line, Curb stop into Home	0	EA		\$ 0.00
Hydrant Assembly	1	EA		
Hand Patching, LVSP	150	TON		
MDOT - Pav't Repr, Nonreinf Conc, 12", Modified	25	SY		
Aggregate Base, 8", 22A	470	SY		
Curb & Gutter, F4	325	LF		
Sidewalk, Conc, 4"	140	SF		
Sidewalk Ramp, Conc, 6"	575	SF		
Detectable Warning Surface	65	LF		
Turf Restoration	1	LS		
Project Cleanup	1	LS		
Traffic Control – Water Daily Closure	8	Per Hole		
Traffic Control – Water Overnight Closure	60	Per Hole		

ITEM DESCRIPTION	EST. QUANT.	UNIT	UNIT COST	TOTAL COST
Traffic Control – Water Detour	1	Per Detour		
Traffic Control – 2 Flaggers w/ advance warning signs	22	Per 4 Hours		
Traffic Control – MDOT Lane Closure	1	LS		
<b>SECTION 1 – WATER MAIN SYSTEM SUBTOTAL:</b>				

Section 1 - Water Main System Subtotal Written Out in Words. In case of discrepancy, the amount shown in words will govern.

**SECTION 2 - Sanitary Sewer System Construction:**

Reconstruct Sanitary Sewer, New Force Main/Lift Station & Spot Replacements:

ITEM DESCRIPTION	QUANT	UNIT	UNIT COST	TOTAL COST
Mobilization – Sanitary Section 2 (Max. 5% of Bid Amount)	1	LS		
Pav't, Rem	90	SY		
HMA, Rem	2,800	SY		
Curb & Gutter, Rem	975	LF		
Bulkhead Ex Sanitary Sewer	1	EA		
Abandon Ex Manhole	3	EA		
Pav't Sawcut – Street Surface	4,600	LF		
By-Pass Pumping	700	LF		
<u>Willow Street</u> San. Sewer, C900 DR18, 8"	360	LF		
<u>Willow Street</u> New 48" Dia. Doghouse MH	2	EA		
<u>W. St. Joe Street</u> San. Sewer, C900 DR18, 8"	305	LF		
<u>W. St. Joe Street</u> New 48" Dia. Doghouse MH	2	EA		
<u>Mechanic Street</u> Sewer, C900 DR18, 10"	325	LF		
<u>Mechanic Street</u>	2	EA		

ITEM DESCRIPTION	QUANT	UNIT	UNIT COST	TOTAL COST
New 48" Dia. Doghouse MH				
<u>Mechanic Street</u> New 48" Dia. Sanitary MH	1	EA		
<u>Marion Street</u> Force Main Sewer, 6"	950	LF		
<u>Marion Street</u> New 48" Dia. Doghouse MH	1	EA		
<u>Marion Street</u> Lift Station Construction	1	LS		
Sanitary Sewer Service Connection	14	EA		
Sanitary Service Connection @ MH	2	EA		
HMA, LVSP	750	TON		
Hand Patching, LVSP	35	TON		
MDOT - HMA, LVSP, 12" thick	70	TON		
Pav't Repr, Nonreinf, Conc, 12", Modified	40	SY		
Sidewalk/Driveway, Conc, 6"	450	SF		
Aggregate Base, 8", 22A	2,800	SY		
Curb & Gutter, F4	975	LF		
Turf Restoration	1	LS		
Project Cleanup	1	LS		
Traffic Control – Willow Street	1	LS		
Traffic Control – W. St. Joe Street	1	LS		
Traffic Control – Marion Street	1	LS		
Traffic Control – Mechanic Street	1	LS		
Traffic Control – Sanitary Spot Replacements	6	Per Site		
Traffic Control – MDOT Lane Shift	1	LS		
<b>SECTION 2 – SANITARY SEWER SYSTEM CONSTRUCTION SUBTOTAL:</b>				

Section 2 - Sanitary Sewer System Construction Subtotal Written Out in Words. In case of discrepancy, the amount shown in words will govern.

**CITY OF HILLSDALE  
DETAILED SCOPE  
WATER VALVE REPLACEMENT PROJECT**

The city is requesting replacement of water system valves that are currently non-operational and/or leaking. This project will be staged to limit water outages to the residents of the city.

**Desired Completion Dates (other completion dates may be considered):**

**Intermediate Water Valve and System Replacement Work: December 31, 2023**  
Includes replacement of 25 valves w/restorations, installation of the 9 new insert valves and completion of the project items on Drawing Sheet W14 including restorations.

**Final Completion Water Valve Replacement Work: November 1, 2024**  
All remaining valve replacements and other items of work not completed in 2023.

~~Water system work shall be completed by December 31, 2023.~~

Water outages and boil water notices will be handled by city staff working closely with the contractor. Coordination and scheduling of work areas will be required by the Contractor with city staff.

The Contractor and subcontractors shall contact the MISS DIG system in accordance with the published rules and regulations of the notification system.

Valve replacements can occur via two options with other options considered by the city:

- Daily Schedule – Contractor will excavate, shut-off water service, replace valve(s), water service restored, and backfilled on the same day.
- Multiple Day Schedule – Day One the contractor will excavate, prepare site, and secure the construction area. Day two the water will be shut-off, valve(s) replaced, water service restored, and backfilled. Only 3 valve areas, per crew, will allowed to be open at any given time. No excavated areas shall remain open for more than one day without approval of the city.

The city will work with the contractor to schedule replacements based on the city's needs. Timing associated with some of the affected properties may require work to be scheduled overnight night or on weekend hours.

It is planned that the replacements will utilize new bolted valves; however, the city has anticipated that tapping valves may be needed in some locations. The contractor shall have a tapping valve on-site during replacements in case it is needed.

For bidding purposes, the city provides the following information:

- Bolted valve quantities are for all identified project sites.
- Tapping valves may be needed at some locations. Pricing for a small quantity of tapping valves is requested in the bid and if used will replace the need for a bolted valve and will be paid at the cost of the tapping valve.
- Live tapped insert valve pricing is requested for sizes noted and should include all costs for installation of the valve. Excavation for this installation will be paid as



**CITY OF HILLSDALE**  
**DETAILED SCOPE**  
**WATER VALVE REPLACEMENT PROJECT**

“Valve Replacement Site Work”. Mobilization for insert valve work will be paid as “Mobilization - Insert Valve” and should include all costs as noted in the Mobilization Special Provision.

- Two sleeves are estimated to be needed for each valve replacement location.
- Reducer pricing is requested as there are valves at the junction of two main sizes, it is unknown as to which main the valve is on. Refer to the table below for the locations where these occur. Water main sizes at valve replacement locations are shown on the project drawings.
- An average of four (4) feet of pipe is estimated for each replacement location.
- New gate valve boxes shall be provided at each replacement location.
- New curb stops and boxes shall be provided at each water service site.
- Temporary patching of excavation location sites shall be topped with a minimum 2” of cold patch material with the cost of this material considered incidental to the work.
- Final restorations of all street openings shall be completed, at a minimum, once per month. MDOT final restorations shall be completed immediately upon completion of the work.
- Pricing for the above items, unless noted otherwise, shall be pricing for the purchase of the item. Contractors will be paid by the actual materials used at each project replacement site. The contractor shall coordinate all quantities for payment with the Project Manager daily during the project.

All work shall be performed promptly and professionally in conjunction with the attached specifications, the 2012 MDOT Standard Specifications for Construction and City of Hillsdale Codes and Ordinances, as applicable.

Removal Items:

- **Pavement Rem, Modified, HMA Rem, Modified, Sidewalk and Curb removals** will be paid by the unit of the actual removals at each location per the standard and special provisions.
- **Hydrant, Abandon** should include all costs for the abandonment of an existing hydrant including the removal of the hydrant and valve box and abandonment of piping to 12” below grade. Water main will be abandoned in place. Removed items shall be undamaged and will remain property of the city.
- **Hydrant, Rem** should include all costs for the removal of an existing hydrant, piping, gate valve and tee in the supply main. Replace the tee with a new section of water main pipe. Removed items shall be undamaged and in one piece and will remain property of the city. Excavation will be paid as “Valve Replacement Site Work”.
- **Valve, Rem, Blank Main** shall include all associated costs to remove the existing water main valve at the main and cap. Excavation will be paid as “Valve Replacement Site Work”.
- **Valve, Rem, Pipe Main** shall include all associated costs to remove the existing valve and install a new pipe section in the main. Excavation will be paid as “Valve Replacement Site Work”.

**CITY OF HILLSDALE**  
**DETAILED SCOPE**  
**WATER VALVE REPLACEMENT PROJECT**

Miscellaneous Items:

- **Pav't Sawcut** shall be per the attached special provision.
- **Valve Replacement Site Work** shall include but not be limited to all labor, materials, equipment, and materials necessary to excavate the estimated eight-foot (8') by eight-foot (8') project area to the water main. Backfill shall be included in this item of work and be in accordance with the Water Typical Details on sheet W15 of the project drawings. Backfill shall be placed and compacted in no greater than (10") lifts to the level required for placement of the aggregate base layer in preparation for paving. This pay item will also be utilized for excavation/backfill associated with new insert valves and identified hydrant work.
- **Overnight/Weekend Valve Replacement Site Work** shall include but not be limited to all labor, materials, equipment, and materials necessary to excavate the estimated eight-foot (8') by eight-foot (8') project area to the water main for replacement of the identified valve. Backfill shall be included in this item of work and be in accordance with the Water Typical Details on sheet W15 of the project drawings. Backfill shall be placed and compacted in no greater than (10") lifts to the level required for placement of the aggregate base layer in preparation for paving. This item shall cover valve replacements started between the hours of 7:00 PM and 7:00 AM or on Saturdays or Sundays.
- **Water Service, Long, 1 inch** shall include but not be limited to all labor, materials, equipment, materials, and excavation/backfill necessary to re-establish the water service, greater than thirty feet (30') in length, from the existing curb stop location to the water main. The current service line shall be cut, crimped and abandoned in place. Bids shall also include the cost for installation of the new curb stop, curb box and all fittings required to connect the new service to the service pipe on the downstream side of the curb box. Backfill and compact with Class II sand or approved on-site material in lifts not to exceed ten inches (10") lifts to the level required for placement of the aggregate base layer in preparation for paving.
- **Hydrant Assembly** shall include but not be limited to all labor, materials, equipment, materials, and excavation/backfill necessary to install a new fire hydrant onto the existing main in accordance with the project typical detail (drawing sheet W15) in the location specified. Hydrant shall be set in 1 yard of coarse gravel for drainage purposes. Backfill and compact with Class II sand or approved on-site material in lifts not to exceed ten inches (10") lifts to the level required for placement of the top soil for turf restoration.
- **Hand Patching, LVSP** shall include but not be limited to all labor, materials, equipment, and materials necessary to install HMA in accordance with specification section 501 at all applicable locations.
- **Pav't Repr, Nonreinf Conc, 12" (<72 Hours)** shall include but not be limited to all labor, materials, equipment, and materials necessary to install "high early" concrete pavement and epoxy anchored lane ties in accordance with specification section 603 and standard detail R-44-F within the MDOT roadway. Concrete pavement will be even with adjacent HMA pavements i.e., no HMA overlay.
- **Aggregate Base, 8", 22A** shall include but not be limited to all labor, materials, equipment, and materials necessary to install aggregate base course in accordance with specification section 302 in the roadway excavation areas.

**CITY OF HILLSDALE  
DETAILED SCOPE  
WATER VALVE REPLACEMENT PROJECT**

- **Curb & Gutter, F4; Conc Sidewalk 4”;** **Conc Ramp 6”;** **Detectable Warning Surface** shall include but not be limited to all labor, materials, equipment, and materials necessary to install concrete elements in accordance with specification section 802, 803 and standard detail R-28-J and R-30-G. Areas of sidewalks removed during project work shall be maintained with Maintenance Gravel until final hard restoration, costs for Maintenance Gravel is considered incidental to the applicable work item. Pedestrian barricades shall be utilized to protect the sidewalk removal area until the maintenance gravel is in place.
- **Turf Restoration** shall include but not be limited to all labor, materials, equipment, and materials necessary to complete Turf Restoration in accordance with the attached special provision at all applicable excavated grass areas. Locations to be included in this LUMP SUM item include but not limited to the areas noted in the below table as affecting grass areas.
- **Project Cleanup** shall include but not be limited to all labor, materials, equipment, and materials necessary to complete Project Cleanup in accordance with the attached special provision.
- **Traffic Control Items** shall include but not be limited to all labor, materials, equipment, and materials necessary to complete Traffic Control Operation in accordance with the attached special provision and Traffic Control Typicals shown on sheet W16 of the project drawings.

**WATER VALVE REPLACEMENT LOCATIONS**

<b>VALVE NUMBER</b>	<b>VALVE LOCATION</b>	<b>SIZE 1</b>	<b>SIZE 2</b>	<b>Material CI/DI</b>	<b>IN PAV'T GRASS or CURB</b>
459	on E Bacon at 115	6		CI	Asphalt
309	on Howell at E Bacon	8		CI	Asphalt over Brick
310	on E Bacon at Howell	12		CI	Asphalt
312	on E Bacon at Howell	12	10	CI	Asphalt
430	on Manning at Bacon E	6		CI	Asphalt
432	on E Bacon at Manning	10	8	CI	Asphalt
282 - Rem	on Wolcott at E Bacon	6		CI	Asphalt & Grass
426	on West at Bacon E	6		CI	Asphalt
563	on Norwood at W Bacon	6	4	CI	Asphalt
333	on Barnard at Griswold	6		CI	Asphalt
334	on Barnard at Griswold	4	6	CI	Asphalt
335	on Griswold at Barnard	6		CI	Asphalt & Grass
525	on Barnard at Greenwood	4		CI	Asphalt
143	in island at N Broad (M-99) and Howell	10	8	DI	Concrete Sidewalk

**CITY OF HILLSDALE  
DETAILED SCOPE  
WATER VALVE REPLACEMENT PROJECT**

<b>VALVE NUMBER</b>	<b>VALVE LOCATION</b>	<b>SIZE 1</b>	<b>SIZE 2</b>	<b>Material CI/DI</b>	<b>IN PAV'T GRASS or CURB</b>
353	on E Carleton at Ferris	6		CI	Grass
18	on W. Carleton (M-99) across from 412 W Carleton	6		DI	MDOT Asphalt over Conc
22	on W Carleton (M-99) at Mechanic	10	6	CI	Grass
INSERT	on W Carelton (M-99) north of Mechanic St	10		CI	Grass
INSERT	on Galloway Dr. within the Wastewater Treatment Plant	10		CI	Grass
INSERT	on W Carleton (M-99) at 401 W Carleton	10		CI	MDOT Asphalt over Conc
INSERT	on W Carleton (M-99) at 290 W Carleton	6		CI	Grass
INSERT	on W Carleton (M-99) at 401 W Carleton	10		CI	MDOT Asphalt over Conc
119	on College at Hillsdale	6	8	CI	Asphalt
122	on Hillsdale at College	10		CI	Asphalt
INSERT	on Union at College	6		DI	Asphalt
50	on College at West	4	6	CI	in Conc. Curb
80	on Manning at E Fayette	6		CI	Asphalt
81	on E Fayette at Manning	8		DI/PVC	Asphalt
111 - Rem	at 225 W Fayette St	6		CI/DI	Asphalt
INSERT	at 225 W Fayette St	6		CI	Asphalt
290	on Ludlam at Griswold	6		CI	Asphalt
336	on LoPresto at Griswold	6		CI	Asphalt
INSERT	on E Hallett at 45 E Hallett	6		CI	Asphalt
472	on Budlong at E Hallett	6		CI	Grass
502	on Manning at Hallett	4	6	CI	Asphalt
497	on West at E Hallett	4	6	CI	Asphalt
518	on Hallett at Reading	6		CI	Asphalt
209	on Hillsdale at Barber	12	10	CI	Concrete Curb
210	on Barber at Hillsdale	12		CI/DI	Asphalt

**CITY OF HILLSDALE  
DETAILED SCOPE  
WATER VALVE REPLACEMENT PROJECT**

<b>VALVE NUMBER</b>	<b>VALVE LOCATION</b>	<b>SIZE 1</b>	<b>SIZE 2</b>	<b>Material CI/DI</b>	<b>IN PAV'T GRASS or CURB</b>
123	on N Manning at River	4	6	CI	Asphalt
261	on Marion at Lombard	4	6	CI	Asphalt & Grass
43	on Mechanic at Arch	8		CI	Asphalt & Grass
438	on Mechanic at Barr	8		CI	Grass
125	on Monroe at West	4	6	CI	Asphalt
482	on Elm at Morry	4	6	CI	Asphalt
546	on N Norwood at Westwood St	6	4	CI	Asphalt
193	on Marion at Oak	12		PVC	Asphalt
69 - Rem	on Oak at River	8		PVC	Asphalt
517	on Rea at Goodrich	4	6	CI	Asphalt
292	on E South at Griswold	6	4	CI	Asphalt
306	on S Howell at E South	8	6	CI	Asphalt
276	on E South at S Manning	6	4	CI	Asphalt & Grass
328	on E South at W St Joe	6		CI	Asphalt
329 - Rem	on W St Joe at E South	12		CI	Asphalt
330	on W St Joe at E South	12		CI/DI	Asphalt
331	on W St Joe at E South	12		CI	Asphalt
332	on E South at W St Joe	10	12	CI	Asphalt
INSERT	on W St Joe at E South	12		CI	Asphalt
559	on W South at S Norwood	6		CI	Asphalt
273	on W South at Reading	6		CI	Asphalt
274	on W South at Reading	6		CI	Asphalt
275	on Reading at W South	6		CI	Asphalt
377	on Lewis at Spring	4		CI	Asphalt
ABAN. HYD	on W. St Joe	12		CI	Grass
NEW HYD	on W St Joe at Barnard	12		DI	Asphalt & Grass
REM HYD	on W. St Joe	12		DI	Asphalt & Grass
SERVICES	on W. St Joe	12		DI	Asphalt & Grass
SERVICES	on W. St Joe	12		DI	Asphalt & Grass

**CITY OF HILLSDALE  
 DETAILED SCOPE  
 WATER VALVE REPLACEMENT PROJECT**

<b>VALVE NUMBER</b>	<b>VALVE LOCATION</b>	<b>SIZE 1</b>	<b>SIZE 2</b>	<b>Material CI/DI</b>	<b>IN PAV'T GRASS or CURB</b>
SERVICES	on W. St Joe	12		DI	Asphalt & Grass
SERVICES	on W. St Joe	12		DI	Asphalt & Grass
SERVICES	on W. St Joe	12		DI	Asphalt & Grass
248	on Riverdale at State	4		CI	Concrete Curb
586	on Salem at State	6	4	CI	Asphalt
53	on Union btwn 81 & 250 Union	12		DI	Asphalt
218	on Union at Barber	12		DI	Asphalt
25	on Waldron at Budlong	6		DI	Asphalt
499	on Armstrong at S West	4		CI	Asphalt
429	on S West at Barry	6		CI	Asphalt
339	on Willow at Lake	6		CI	Asphalt

**CITY OF HILLSDALE**  
**DETAILED SCOPE**  
**SANITARY SEWER LINING AND REPLACEMENT PROJECT INFORMATION**

The city is requesting completion of the following major items of work:

- Sanitary Sewer CIPP Lining – 10 locations, 15 Pipe Sections, 3,470 LF
- Sanitary Sewer Full Replacement – 3 Locations, 990 LF
- Sanitary Sewer Spot Replacement – 7 Locations, 115 LF
- Sanitary Sewer Force Main Construction with one lift station – 1 Location, 950 LF

Sanitary sewer and restoration work shall be completed by ~~August 30, 2024~~ **November 1, 2024**

The Contractor and subcontractors shall contact the MISS DIG system in accordance with the published rules and regulations of the notification system.

Temporary patching of spot replacement location sites shall be topped with 2" minimum of cold patch material with the cost of this material considered incidental to the work.

Final restorations of street openings for spot replacements shall be completed within 30 days of the opening. MDOT final restorations shall be completed immediately upon completion of the work.

All work shall be performed promptly and professionally in conjunction with the attached specifications, the 2012 MDOT Standard Specifications for Construction and City of Hillsdale Codes and Ordinances, as applicable.

Removal Items:

- **Pavement Rem, Modified, HMA Rem, Modified, Sidewalk/Driveway and Curb removals** will be paid by the unit of the actual removals at each location per the standard and special provisions.
- **Bulkhead Ex Sanitary Sewer** contractor shall cut and cap the existing sanitary sewer five feet (5') from the existing manhole and fill the pipe to the manhole with flowable fill.
- **Abandon Ex Manhole** contractor shall demolish and remove from the site the existing manhole materials to approximately 36" below grade and bulkhead any existing piping in the manhole. Backfill the manhole with clean sand fill materials compacted in lifts no greater 12".

Miscellaneous Items – Reconstruction, Force Main/Lift Station, & Spot Replacements:

- **Pav't Sawcut** shall be per the attached special provision.
- **By-Pass Pumping** shall be in accordance with the Sanitary Sewer Standard and paid by the LF of sanitary sewer by-passed, as needed.
- **Sanitary Sewer, 6 or 8 or 10 inch, Tr Det B** shall include but not be limited to all labor, materials, equipment, materials, excavations and backfill necessary to install the sanitary sewer/force main in accordance with the attached Sanitary Sewer Standard. Sewer piping shall be measured horizontally along pipe

"General Decision Number: MI20230001 02/17/2023

Superseded General Decision Number: MI20220001

State: Michigan

Construction Types: Highway (Highway, Airport & Bridge xxxxx and Sewer/Incid. to Hwy.)

Counties: Michigan Statewide.

Note: Contracts subject to the Davis-Bacon Act are generally required to pay at least the applicable minimum wage rate required under Executive Order 14026 or Executive Order 13658. Please note that these Executive Orders apply to covered contracts entered into by the federal government that are subject to the Davis-Bacon Act itself, but do not apply to contracts subject only to the Davis-Bacon Related Acts, including those set forth at 29 CFR 5.1(a)(2)-(60).

If the contract is entered into on or after January 30, 2022, or the contract is renewed or extended (e.g., an option is exercised) on or after January 30, 2022:	. Executive Order 14026 generally applies to the contract. . The contractor must pay all covered workers at least \$16.20 per hour (or the applicable wage rate listed on this wage determination, if it is higher) for all hours spent performing on the contract in 2023.
If the contract was awarded on or between January 1, 2015 and January 29, 2022, and the contract is not renewed or extended on or after January 30, 2022:	. Executive Order 13658 generally applies to the contract. . The contractor must pay all covered workers at least \$12.15 per hour (or the applicable wage rate listed on this wage determination, if it is higher) for all hours spent performing on that contract in 2023.

The applicable Executive Order minimum wage rate will be adjusted annually. If this contract is covered by one of the Executive Orders and a classification considered necessary for performance of work on the contract does not appear on this wage determination, the contractor must still submit a conformance request.

Additional information on contractor requirements and worker protections under the Executive Orders is available at <http://www.dol.gov/whd/govcontracts>.

Modification Number	Publication Date
0	01/06/2023
1	02/03/2023
2	02/17/2023



CARP0004-004 06/01/2019

REMAINDER OF STATE

	Rates	Fringes
CARPENTER ( Piledriver).....	\$ 27.62	20.59

-----  
CARP0004-005 06/01/2018

LIVINGSTON (Townships of Brighton, Deerfield, Genoa, Hartland, Oceola & Tyrone), MACOMB, MONROE, OAKLAND, SANILAC, ST. CLAIR AND WAYNE COUNTIES

	Rates	Fringes
CARPENTER (Piledriver).....	\$ 30.50	27.28

-----  
ELEC0017-005 06/01/2022

STATEWIDE

	Rates	Fringes
Line Construction		
Groundman/Driver.....	\$ 29.57	7.20+32%
Journeyman Signal Tech, Communications Tech, Tower Tech & Fiber Optic Splicers.	\$ 43.90	7.20+32%
Journeyman Specialist.....	\$ 50.49	7.20+32%
Operator A.....	\$ 37.13	7.20+32%
Operator B.....	\$ 34.67	7.20+32%

Classifications

Journeyman Specialist: Refers to a crew of only one person working alone.  
 Operator A: Shall be proficient in operating all power equipment including: Backhoe, Excavator, Directional Bore and Boom/Digger truck.  
 Operator B: Shall be proficient in operating any 2 of the above mentioned pieces of equipment listed under Operator A.

-----  
ENGI0324-003 06/01/2022

ALCONA, ALPENA, ARENAC, BAY, CHEBOYGAN, CLARE, CLINTON, CRAWFORD, GENESEE, GLADWIN, GRATIOT, HURON, INGHAM, IOSCO, ISABELLA, JACKSON, LAPEER, LENAWEE, LIVINGSTON, MACOMB, MIDLAND, MONROE, MONTMORENCY, OAKLAND, OGEMAW, OSCODA, OTSEGO, PRESQUE ISLE, ROSCOMMON, SAGINAW, ST. CLAIR, SANILAC, SHIAWASSEE, TUSCOLA, WASHTENAW AND WAYNE COUNTIES:

	Rates	Fringes
OPERATOR: Power Equipment (Steel Erection)		
GROUP 1.....	\$ 51.02	24.85
GROUP 2.....	\$ 52.02	24.85
GROUP 3.....	\$ 49.52	24.85
GROUP 4.....	\$ 50.52	24.85

GROUP 5.....	\$ 48.02	24.85
GROUP 6.....	\$ 49.02	24.85
GROUP 7.....	\$ 47.75	24.85
GROUP 8.....	\$ 48.75	24.85
GROUP 9.....	\$ 47.30	24.85
GROUP 10.....	\$ 48.30	24.85
GROUP 11.....	\$ 46.57	24.85
GROUP 12.....	\$ 47.57	24.85
GROUP 13.....	\$ 46.21	24.85
GROUP 14.....	\$ 47.21	24.85
GROUP 15.....	\$ 45.57	24.85
GROUP 16.....	\$ 42.37	24.85
GROUP 17.....	\$ 27.89	12.00
GROUP 18.....	\$ 31.38	24.85

FOOTNOTE:

Paid Holidays: New Year's Day, Memorial Day, Fourth of July, Labor Day, Thanksgiving Day and Christmas Day.

POWER EQUIPMENT OPERATOR CLASSIFICATIONS

GROUP 1: Engineer when operating combination of boom and jib 400' or longer

GROUP 2: Engineer when operating combination of boom and jib 400' or longer on a crane that requires an oiler

GROUP 3: Engineer when operating combination of boom and jib 300' or longer

GROUP 4: Engineer when operating combination of boom and jib 300' or longer on a crane that requires an oiler

GROUP 5: Engineer when operating combination of boom and jib 220' or longer

GROUP 6: Engineer when operating combination of boom and jib 220' or longer on a crane that requires an oiler

GROUP 7: Engineer when operating combination of boom and jib 140' or longer

GROUP 8: Engineer when operating combination of boom and jib 140' or longer on a crane that requires an oiler

GROUP 9: Tower crane & derrick operator (where operator's work station is 50 ft. or more above first sub-level)

GROUP 10: Tower crane & derrick operator (where operator's work station is 50 ft. or more above first sub-level) on a crane that requires an oiler

GROUP 11: Engineer when operating combination of boom and jib 120' or longer

GROUP 12: Engineer when operating combination of boom and jib 120' or longer on a crane that requires an oiler

GROUP 13: Crane operator; job mechanic and 3 drum hoist and excavator

GROUP 14: Crane operator on a crane that requires an oiler

GROUP 15: Hoisting operator; 2 drum hoist and rubber tired

backhoe

GROUP 16: Forklift and 1 drum hoist

GROUP 17: Compressor or welder operator

GROUP 18: Oiler

-----  
ENGI0324-004 06/01/2022

AREA 1: ALLEGAN, BARRY, BERRIEN, BRANCH, CALHOUN, CASS, EATON, HILLSDALE, IONIA, KALAMAZOO, KENT, LAKE, MANISTEE, MASON, MECOSTA, MONTCALM, MUSKEGON, NEWAYGO, OCEANA, OSCEOLA, OTTAWA, ST. JOSEPH, VAN BUREN

AREA 2: ANTRIM, BENZIE, CHARLEVOIX, EMMET, GRAND TRAVERSE, KALKASKA, LEELANAU, MISSAUKEE AND WEXFORD COUNTIES:

	Rates	Fringes
OPERATOR: Power Equipment (Steel Erection)		
AREA 1		
GROUP 1.....	\$ 51.02	24.85
GROUP 2.....	\$ 47.75	24.85
GROUP 3.....	\$ 46.21	24.85
GROUP 4.....	\$ 42.37	24.85
GROUP 5.....	\$ 27.89	12.00
GROUP 6.....	\$ 31.38	24.85
AREA 2		
GROUP 1.....	\$ 51.02	24.85
GROUP 2.....	\$ 47.75	24.85
GROUP 3.....	\$ 46.21	24.85
GROUP 4.....	\$ 42.37	24.85
GROUP 5.....	\$ 27.89	12.00
GROUP 6.....	\$ 31.38	24.85

FOOTNOTES:

Crane operator with main boom and jib 300' or longer: \$1.50 additional to the group 1 rate. Crane operator with main boom and jib 400' or longer: \$3.00 additional to the group 1 rate.

PAID HOLIDAYS: New Year's Day, Memorial Day, Fourth of July, Labor Day, Thanksgiving Day and Christmas Day.

POWER EQUIPMENT OPERATOR CLASSIFICATIONS:

GROUP 1: Crane Operator with main boom & jib 400', 300', or 220' or longer.

GROUP 2: Crane Operator with main boom & jib 140' or longer, Tower Crane; Gantry Crane; Whirley Derrick.

GROUP 3: Regular Equipment Operator, Crane, Dozer, Loader, Hoist, Straddle Wagon, Mechanic, Grader and Hydro Excavator.

GROUP 4: Air Tugger (single drum), Material Hoist Pump 6" or over, Elevators, Brokk Concrete Breaker.

GROUP 5: Air Compressor, Welder, Generators, Conveyors

GROUP 6: Oiler and fire tender

AREA 1: GENESEE, LAPEER, LIVINGSTON, MACOMB, MONROE, OAKLAND,  
 ST. CLAIR, WASHTENAW AND WAYNE COUNTIES

AREA 2: ALCONA, ALLEGAN, ALGER, ALPENA, ANTRIM, ARENAC, BARAGA,  
 BARRY, BAY, BENZIE, BERRIEN, BRANCH, CALHOUN, CASS,  
 CHARLEVOIX, CHEBOYGAN, CHIPPEWA, CLARE, CLINTON, CRAWFORD,  
 DELTA, DICKINSON, EATON, EMMET, GLADWIN, GOGEBIC, GRAND  
 TRAVERSE, GRATIOT, HILLSDALE, HOUGHTON, HURON, INGHAM, IONIA,  
 IOSCO, IRON, ISABELLA, JACKSON, KALAMAZOO, KALKASKA, KENT,  
 KWEENAW, LAKE, LEELANAU, LENAWEE, LUCE, MACKINAC, MANISTEE,  
 MARQUETTE, MASON, MECOSTA, MENOMINEE, MIDLAND, MISSAUKEE,  
 MONTCALM, MONTMORENCY, MUSKEGON, NEWAYGO, OCEANA, OGEMAW,  
 ONTONAGON, OSCEOLA, OSCODA, OTSEGO, OTTAWA, PRESQUE ISLE,  
 ROSCOMMON, SAGINAW, SANILAC, SCHOOLCRAFT, SHIAWASSEE, ST.  
 JOSEPH, TUSCOLA, VAN BUREN AND WEXFORD COUNTIES

	Rates	Fringes
OPERATOR: Power Equipment (Underground construction (including sewer))		
AREA 1:		
GROUP 1.....	\$ 39.38	24.85
GROUP 2.....	\$ 34.65	24.85
GROUP 3.....	\$ 33.92	24.85
GROUP 4.....	\$ 33.35	24.85
GROUP 5.....	\$ 24.90	12.05
AREA 2:		
GROUP 1.....	\$ 37.67	24.85
GROUP 2.....	\$ 32.78	24.85
GROUP 3.....	\$ 32.28	24.85
GROUP 4.....	\$ 32.00	24.85
GROUP 5.....	\$ 24.90	12.05

POWER EQUIPMENT OPERATOR CLASSIFICATIONS

GROUP 1: Backfiller tamper; Backhoe; Batch plant operator  
 (concrete); Clamshell; Concrete paver (2 drums or larger);  
 Conveyor loader (Euclid type); Crane (crawler, truck type  
 or pile driving); Dozer; Dragline; Elevating grader;  
 Endloader; Gradall (and similar type machine); Grader;  
 Mechanic; Power shovel; Roller (asphalt); Scraper  
 (self-propelled or tractor drawn); Side boom tractor (type  
 D-4 or equivalent and larger); Slip form paver; Slope  
 paver; Trencher (over 8 ft. digging capacity); Well  
 drilling rig; Concrete pump with boom operator; Hydro  
 Excavator

GROUP 2: Boom truck (power swing type boom); Crusher; Hoist;  
 Pump (1 or more - 6-in. discharge or larger - gas or  
 diesel- powered or powered by generator of 300 amperes or  
 more - inclusive of generator); Side boom tractor (smaller  
 than type D-4 or equivalent); Tractor (pneu-tired, other  
 than backhoe or front end loader); Trencher (8-ft. digging  
 capacity and smaller); Vac Truck and End dump operator;

GROUP 3: Air compressors (600 cfm or larger); Air compressors  
 (2 or more-less than 600 cfm); Boom truck (non-swinging,  
 non- powered type boom); Concrete breaker (self-propelled  
 or truck mounted - includes compressor); Concrete paver (1

drum-1/2 yd. or larger); Elevator (other than passenger); Maintenance person; Pump (2 or more-4-in. up to 6-in. discharge-gas or diesel powered - excluding submersible pumps); Pumpcrete machine (and similar equipment); Wagon drill (multiple); Welding machine or generator (2 or more-300 amp. or larger - gas or diesel powered)

GROUP 4: Boiler; Concrete saw (40 hp or over); Curing machine (self-propelled); Farm tractor (with attachment); Finishing machine (concrete); Hydraulic pipe pushing machine; Mulching equipment; Pumps (2 or more up to 4-in. discharge, if used 3 hours or more a day, gas or diesel powered - excluding submersible pumps); Roller (other than asphalt); Stump remover; Trencher (service); Vibrating compaction equipment, self-propelled (6 ft. wide or over); Sweeper (Wayne type); Water wagon and Extend-a boom forklift

Group 5: Fire Person, Oiler

-----  
 \* ENGI0324-006 06/01/2022

GENESEE, MACOMB, MONROE, OAKLAND, WASHTENAW, WAYNE, ALCONA, ALGER, ALLEGAN, ALPENA, ANTRIM, ARENAC, BARAGA, BARRY, BAY, BENZIE, BERRIEN, BRANCH, CALHOUN, CASS, CHARLEVOIX, CHEBOYGAN, CHIPPEWA, CLARE, CLINTON, CRAWFORD, DELTA, DICKINSON, EATON, EMMET, GLADWIN, GOGEBIC, GRAND TRAVERSE, GRATIOT, HILLSDALE, HOUGHTON, HURON, INGHAM, IONIA, IOSCO, IRON, ISABELLA, JACKSON, KALAMAZOO, KALKASKA, KENT, KEWEENAW, LAKE, LAPEER, LEELANAU, LENAWEE, LIVINGSTON, LUCE, MACKINAC, MANISTEE, MARQUETTE, MASON, MECOSTA, MENOMINEE, MIDLAND, MISSAUKEE, MONTCALM, MONTMORENCY, MUSKEGON, NEWAYGO, OCEANA, OGEMAW, ONTONAGON, OSCEOLA, OSCODA, OTSEGO, OTTAWA, PRESQUE ISLE, ROSCOMMON, SAGINAW, ST. CLARE, ST. JOSEPH, SANILAC, SCHOOLCRAFT, SHIAWASSEE, TUSCOLA, VAN BUREN AND WEXFORD COUNTIES

	Rates	Fringes
Power equipment operators: (AIRPORT, BRIDGE & HIGHWAY CONSTRUCTION)		
GROUP 1.....	\$ 38.86	24.85
GROUP 2.....	\$ 32.13	24.85
GROUP 3.....	\$ 31.57	24.85
GROUP 4.....	\$ 31.40	24.85

POWER EQUIPMENT OPERATOR CLASSIFICATIONS

GROUP 1: Asphalt plant operator; Crane operator (does not include work on bridge construction projects when the crane operator is erecting structural components); Dragline operator; Shovel operator; Locomotive operator; Paver operator (5 bags or more); Elevating grader operator; Pile driving operator; Roller operator (asphalt); Blade grader operator; Trenching machine operator (ladder or wheel type); Auto-grader; Slip form paver; Self-propelled or tractor-drawn scraper; Conveyor loader operator (Euclid type); Endloader operator (1 yd. capacity and over); Bulldozer; Hoisting engineer; Tractor operator; Finishing machine operator (asphalt); Mechanic; Pump operator (6-in. discharge or over, gas, diesel powered or generator of 300 amp. or larger); Shouldering or gravel distributing machine operator (self-propelled); Backhoe (with over 3/8 yd. bucket); Side boom tractor (type D-4 or equivalent or

larger); Tube finisher (slip form paving); Gradall (and similar type machine); Asphalt paver (self-propelled); Asphalt planer (self-propelled); Batch plant (concrete-central mix); Slurry machine (asphalt); Concrete pump (3 in. and over); Roto-mill; Swinging boom truck (over 12 ton capacity); Hydro demolisher (water blaster); Farm-type tractor with attached pan; Vacuum truck operator; Batch Plant (concrete dry batch); Concrete Saw Operator (40h.p. or over; Tractor Operator (farm type); Finishing Machine Operator (concrete); Grader Operator (self-propelled fine grade or form (concrete)).

GROUP 2: Screening plant operator; Washing plant operator; Crusher operator; Backhoe (with 3/8 yd. bucket or less); Side boom tractor (smaller than D-4 type or equivalent); Sweeper (Wayne type and similar equipment); Greese Truck; Air Compressor Operator (600 cu.ft. per min or more); Air Compressor Operator (two or more, less than 600 cfm);

GROUP 3: Boiler fire tender; Tractor operator (farm type with attachment); Concrete Breaker; Wagon Drill Operator;

GROUP 4: Oiler; Fire tender; Trencher (service); Flexplane operator; Cleftplane operator; Boom or winch hoist truck operator; Endloader operator \*under 1 yd. capacity); Roller Operator (other than asphalt); Curing equipment operator (self-propelled); Power bin operator; Plant drier (6 ft. wide or over); Guard post driver operator (power driven); All mulching equipment; Stump remover; Concrete pump (under 3-in.); Mesh installer (self-propelled); End dump; Skid Steer.

-----  
 ENGI0324-007 05/01/2022

ALGER, BARAGA, CHIPPEWA, DELTA, DICKINSON, GOGEBIC, HOUGHTON, IRON, KEWEENAW, LUCE, MACKINAC MARQUETTE, MENOMINEE, ONTONAGON AND SCHOOLCRAFT COUNTIES:

	Rates	Fringes
OPERATOR: Power Equipment (Steel Erection)		
Compressor, welder and forklift.....	\$ 37.40	24.60
Crane operator, main boom & jib 120' or longer.....	\$ 43.87	24.60
Crane operator, main boom & jib 140' or longer.....	\$ 44.17	24.60
Crane operator, main boom & jib 220' or longer.....	\$ 44.17	24.60
Mechanic with truck and tools.....	\$ 43.00	24.60
Oiler and fireman.....	\$ 35.86	24.60
Regular operator.....	\$ 41.22	24.60

-----  
 ENGI0324-008 10/01/2020

ALCONA, ALGER, ALLEGAN, ALPENA, ANTRIM, ARENAC, BARAGA, BARRY, BAY, BENZIE, BERRIEN, BRANCH, CALHOUN, CASS, CHARLEVOIX, CHEBOYGAN, CHIPPEWA, CLARE, CLINTON, CRAWFORD, DELTA, DICKINSON, EATON, EMMET, GENESEE, GLADWIN, GOGEBIC, GRAND TRAVERSE, GRATIOT, HILLSDALE, HOUGHTON, HURON, INGHAM, IONIA, IOSCO, IRON, ISABELLA, JACKSON, KALAMAZOO, KALKASKA, KENT,

KEWEENAW, LAKE, LAPEER, LEELANAU, LENAWEE, LIVINGSTON, LUCE, MACKINAC, MACOMB, MANISTEE, MARQUETTE, MASON, MECOSTA, MENOMINEE, MIDLAND, MISSAUKEE, MONTCALM, MONTMORENCY, MONROE, MUSKEGON, NEWAYGO, OAKLAND, OCEANA, OGEMAW, ONTONAGON, OSCEOLA, OSCODA, OTSEGO, OTTAWA, PRESQUE ISLE, ROSCOMMON, SAGINAW, ST. CLARE, ST. JOSEPH, SANILAC, SCHOOLCRAFT, SHIAWASSEE, TUSCOLA, VAN BUREN, WASHTENAW, WAYNE AND WEXFORD COUNTIES

	Rates	Fringes
OPERATOR: Power Equipment (Sewer Relining)		
GROUP 1.....	\$ 35.37	14.31
GROUP 2.....	\$ 33.33	14.31

SEWER RELINING CLASSIFICATIONS

GROUP 1: Operation of audio-visual closed circuit TV system, including remote in-ground cutter and other equipment used in connection with the CCTV system

GROUP 2: Operation of hot water heaters and circulation systems, water jettors and vacuum and mechanical debris removal systems

-----  
ENGI0325-012 05/01/2022

	Rates	Fringes
Power equipment operators - gas distribution and duct installation work:		
GROUP 1.....	\$ 34.83	24.85
GROUP 2.....	\$ 32.55	24.85

SCOPE OF WORK: The construction, installation, treating and reconditioning of pipelines transporting gas vapors within cities, towns, subdivisions, suburban areas, or within private property boundaries, up to and including private meter settings of private industrial, governmental or other premises, more commonly referred to as ""distribution work,"" starting from the first metering station, connection, similar or related facility, of the main or cross country pipeline and including duct installation.

Group 1: Backhoe, crane, grader, mechanic, dozer (D-6 equivalent or larger), side boom (D-4 equivalent or larger), trencher(except service), endloader (2 yd. capacity or greater).

GROUP 2: Dozer (less than D-6 equivalent), endloader (under 2 yd. capacity), side boom (under D-4 capacity), backfiller, pumps (1 or 2 of 6-inch discharge or greater), boom truck (with powered boom), tractor (wheel type other than backhoe or front endloader). Tamper (self-propelled), boom truck (with non-powered boom), concrete saw (20 hp or larger), pumps (2 to 4 under 6-inch discharge), compressor (2 or more or when one is used continuously into the second day) and trencher(service). Oiler, hydraulic pipe pushing machine, grease person and hydrostatic testing operator.

-----  
IRON0008-007 06/01/2022

ALGER, BARAGA, CHIPPEWA, DELTA, DICKINSON, GOGEBIC, HOUGHTON,  
 IRON, KEWEENAW, LUCE, MACKINAC MARQUETTE, MENOMINEE, ONTONAGON  
 AND SCHOOLCRAFT COUNTIES:

	Rates	Fringes
Ironworker - pre-engineered metal building erector.....	\$ 23.70	6.95
IRONWORKER		
General contracts		
\$10,000,000 or greater.....	\$ 38.14	28.70
General contracts less		
than \$10,000,000.....	\$ 38.14	28.70

Paid Holidays: New Year's Day, Memorial Day, July 4th, Labor  
 Day, Thanksgiving Day & Christmas Day.

-----  
 IRON0025-002 06/01/2022

ALCONA, ALPENA, ARENAC, BAY, CHEBOYGAN, CLARE, CLINTON,  
 CRAWFORD, GENESEE, GLADWIN, GRATIOT, HURON, INGHAM, IOSCO,  
 ISABELLA, JACKSON, LAPEER, LIVINGSTON, MACOMB, MIDLAND,  
 MONTMORENCY, OAKLAND, OGEMAW, OSCODA, OTSEGO, PRESQUE ISLE,  
 ROSCOMMON, SAGINAW, SANILAC, SHIAWASSEE, ST. CLAIR, TUSCOLA,  
 WASHTENAW AND WAYNE COUNTIES:

	Rates	Fringes
Ironworker - pre-engineered metal building erector		
ALLEGAN, ANTRIM, BARRY, BENZIE, BRANCH, CALHOUN, CHARLEVOIX, EATON, EMMET, GRAND TRAVERSE, HILLSDALE, IONIA, KALAMAZOO, KALKASKA, KENT, LAKE, LEELANAU, MANISTEE, MASON, MECOSTA, MISSAUKEE, MONTCALM, MUSKEGON, NEWAYGO, OCEANA, OSCEOLA, OTTAWA, ST. JOSEPH, VAN BUREN AND WEXFORD COUNTIES:..	\$ 24.59	25.43
Bay, Genesee, Lapeer, Livingston (east of Burkhardt Road), Macomb, Midland, Oakland, Saginaw, St. Clair, The University of Michigan, Washtenaw (east of U.S. 23) & Wayne...	\$ 25.81	26.43
IRONWORKER		
Ornamental and Structural...	\$ 34.50	38.44
Reinforcing.....	\$ 31.43	34.77

-----  
 IRON0055-005 07/01/2022

LENAWEE AND MONROE COUNTIES:

	Rates	Fringes
IRONWORKER		
Pre-engineered metal		



buildings.....	\$ 23.59	19.35
All other work.....	\$ 33.00	27.20

-----  
 IRON0292-003 06/01/2020

BERRIEN AND CASS COUNTIES:

	Rates	Fringes
IRONWORKER (Including pre-engineered metal building erector).....	\$ 31.75	22.84

-----  
 LAB00005-006 10/01/2022

	Rates	Fringes
Laborers - hazardous waste abatement: (ALCONA, ALPENA, ANTRIM, BENZIE, CHARLEVOIX, CHEBOYGAN, CRAWFORD, EMMET, GRAND TRAVERSE, IOSCO, KALKASKA, LEELANAU, MISSAUKEE, MONTMORENCY, OSCODA, OTSEGO, PRESQUE ISLE AND WEXFORD COUNTIES - Zone 10)		
Levels A, B or C.....	\$ 17.45	12.75
class b.....	\$ 18.64	12.90
Work performed in conjunction with site preparation not requiring the use of personal protective equipment;		
Also, Level D.....	\$ 16.45	12.75
class a.....	\$ 17.64	12.90
Zone 10		
Laborers - hazardous waste abatement: (ALGER, BARAGA, CHIPPEWA, DELTA, DICKINSON, GOGEBIC, HOUGHTON, IRON, KEWEENAW, LUCE, MACKINAC, MARQUETTE, MENOMINEE, ONTONAGON AND SCHOOLCRAFT COUNTIES - Zone 11)		
Levels A, B or C.....	\$ 25.18	12.90
Work performed in conjunction with site preparation not requiring the use of personal protective equipment;		
Also, Level D.....	\$ 22.58	12.90
Laborers - hazardous waste abatement: (ALLEGAN, BARRY, BERRIEN, BRANCH, CALHOUN, CASS, IONIA COUNTY (except the city of Portland); KALAMAZOO, KENT, LAKE, MANISTEE, MASON, MECOSTA, MONTCALM, MUSKEGON, NEWAYGO, OCEANA, OSCEOLA, OTTAWA, ST. JOSEPH AND VAN BUREN COUNTIES - Zone 9)		
Levels A, B or C.....	\$ 21.88	13.26
Work performed in		

conjunction with site preparation not requiring the use of personal protective equipment; Also, Level D.....\$ 20.80	12.90
Laborers - hazardous waste abatement: (ARENAC, BAY, CLARE, GLADWIN, GRATIOT, HURON, ISABELLA, MIDLAND, OGEMAW, ROSCOMMON, SAGINAW AND TUSCOLA COUNTIES - Zone 8)	
Levels A, B or C.....\$ 23.74	12.95
Work performed in conjunction with site preparation not requiring the use of personal protective equipment; Also, Level D.....\$ 20.80	12.90
Laborers - hazardous waste abatement: (CLINTON, EATON AND INGHAM COUNTIES; IONIA COUNTY (City of Portland); LIVINGSTON COUNTY (west of Oak Grove Rd., including the City of Howell) - Zone 6)	
Levels A, B or C.....\$ 26.33	12.95
Work performed in conjunction with site preparation not requiring the use of personal protective equipment; Also, Level D.....\$ 24.64	12.90
Laborers - hazardous waste abatement: (GENESEE, LAPEER AND SHIAWASSEE COUNTIES - Zone 7)	
Levels A, B or C.....\$ 24.20	13.80
Work performed in conjunction with site preparation not requiring the use of personal protective equipment; Also, Level D.....\$ 23.20	13.80
Laborers - hazardous waste abatement: (HILLSDALE, JACKSON AND LENAWEЕ COUNTIES - Zone 4)	
Levels A, B or C.....\$ 27.13	14.95
Work performed in conjunction with site preparation not requiring the use of personal protective equipment; Also, Level D.....\$ 24.17	12.90
Laborers - hazardous waste abatement: (LIVINGSTON COUNTY (east of Oak Grove Rd. and south of M-59, excluding the city of Howell); AND WASHTENAW COUNTY - Zone 3)	
Levels A, B or C.....\$ 29.93	14.20
Work performed in conjunction with site preparation not requiring the use of personal	

protective equipment; Also, Level D.....	\$ 28.93	14.20
Laborers - hazardous waste abatement: (MACOMB AND WAYNE COUNTIES - Zone 1)		
Levels A, B or C.....	\$ 29.93	16.90
Work performed in conjunction with site preparation not requiring the use of personal protective equipment;		
Also, Level D.....	\$ 28.93	16.90
Laborers - hazardous waste abatement: (MONROE COUNTY - Zone 4)		
Levels A, B or C.....	\$ 31.75	14.90
Work performed in conjunction with site preparation not requiring the use of personal protective equipment;		
Also, Level D.....	\$ 31.75	14.90
Laborers - hazardous waste abatement: (OAKLAND COUNTY and the Northeast portion of LIVINGSTON COUNTY bordered by Oak Grove Road on the West and M-59 on the South - Zone 2)		
Level A, B, C.....	\$ 29.93	16.90
Work performed in conjunction with site preparation not requiring the use of personal protective equipment;		
Also, Level D.....	\$ 28.93	16.90
Laborers - hazardous waste abatement: (SANILAC AND ST. CLAIR COUNTIES - Zone 5)		
Levels A, B or C.....	\$ 26.21	16.62
Work performed in conjunction with site preparation not requiring the use of personal protective equipment;		
Also, Level D.....	\$ 24.75	16.35

-----  
LAB00259-001 09/01/2022

AREA 1: MACOMB, OAKLAND AND WAYNE COUNTIES  
AREA 2: ALCONA, ALGER, ALLEGAN, ALPENA, ANTRIM, ARENAC, BARAGA,  
BARRY, BAY, BENZIE, BERRIEN, BRANCH, CALHOUN, CASS, CHARLEVOIX,  
CHEBOYGAN, CHIPPEWA, CLARE, CLINTON, CRAWFORD, DELTA,  
DICKINSON, EATON, EMMET, GENESEE, GLADWIN, GOGEBIC, GRAND  
TRAVERSE, GRATIOT, HILLSDALE, HOUGHTON, HURON, INGHAM, IONIA,  
IOSCO, IRON, ISABELLA, JACKSON, KALAMAZOO, KALKASKA, KENT,  
KEWEENAW, LAKE, LAPEER, LEELANAU, LENAWEE, LIVINGSTON, LUCE,  
MACKINAC, MANISTEE, MARQUETTE, MASON, MECOSTA, MENOMINEE,  
MIDLAND, MISSAUKEE, MONROE, MONTCALM, MONTMORENCY, MUSKEGON,  
NEWAYGO, OCEANA, OGEMAW, ONTONAGON, OSCEOLA, OSCODA, OTSEGO,  
OTTAWA, PRESQUE ISLE, ROSCOMMON, SAGINAW, ST. CLARE, ST.  
JOSEPH, SANILAC, SCHOOLCRAFT, SHIAWASSEE, TUSCOLA, VAN BUREN,  
WASHTENAW AND WEXFORD COUNTIES

	Rates	Fringes
Laborers - tunnel, shaft and caisson:		
AREA 1		
GROUP 1.....	\$ 23.62	16.95
GROUP 2.....	\$ 23.73	19.95
GROUP 3.....	\$ 23.79	16.95
GROUP 4.....	\$ 23.97	16.95
GROUP 5.....	\$ 24.22	16.95
GROUP 6.....	\$ 24.55	16.95
GROUP 7.....	\$ 17.83	16.95
AREA 2		
GROUP 1.....	\$ 25.15	12.95
GROUP 2.....	\$ 25.24	12.95
GROUP 3.....	\$ 25.34	12.95
GROUP 4.....	\$ 25.50	12.95
GROUP 5.....	\$ 25.76	12.95
GROUP 6.....	\$ 26.07	12.95
GROUP 7.....	\$ 18.34	12.95

SCOPE OF WORK: Tunnel, shaft and caisson work of every type and description and all operations incidental thereto, including, but not limited to, shafts and tunnels for sewers, water, subways, transportation, diversion, sewerage, caverns, shelters, aquifers, reservoirs, missile silos and steel sheeting for underground construction.

#### TUNNEL LABORER CLASSIFICATIONS

GROUP 1: Tunnel, shaft and caisson laborer, dump, shanty, hog house tender, testing (on gas) and watchman

GROUP 2: Manhole, headwall, catch basin builder, bricklayer tender, mortar machine and material mixer

GROUP 3: Air tool operator (jackhammer, bush hammer and grinder), first bottom, second bottom, cage tender, car pusher, carrier, concrete, concrete form, concrete repair, cement invert laborer, cement finisher, concrete shoveler, conveyor, floor, gasoline and electric tool operator, gunite, grout operator, welder, heading dinky person, inside lock tender, pea gravel operator, pump, outside lock tender, scaffold, top signal person, switch person, track, tugger, utility person, vibrator, winch operator, pipe jacking, wagon drill and air track operator and concrete saw operator (under 40 h.p.)

GROUP 4: Tunnel, shaft and caisson mucker, bracer, liner plate, long haul dinky driver and well point

GROUP 5: Tunnel, shaft and caisson miner, drill runner, key board operator, power knife operator, reinforced steel or mesh (e.g. wire mesh, steel mats, dowel bars, etc.)

GROUP 6: Dynamite and powder

GROUP 7: Restoration laborer, seeding, sodding, planting, cutting, mulching and top soil grading; and the restoration of property such as replacing mailboxes, wood chips, planter boxes, flagstones, etc.

---

\* LAB00334-001 09/01/2022

	Rates	Fringes
Laborers - open cut:		
ZONE 1 - MACOMB, OAKLAND AND WAYNE COUNTIES:		
GROUP 1.....	\$ 23.47	16.95
GROUP 2.....	\$ 23.58	16.95
GROUP 3.....	\$ 23.63	16.95
GROUP 4.....	\$ 23.71	16.95
GROUP 5.....	\$ 24.17	16.95
GROUP 6.....	\$ 21.22	16.95
GROUP 7.....	\$ 17.84	16.95
ZONE 2 - LIVINGSTON COUNTY (east of M-151 (Oak Grove Rd.)); MONROE AND WASHTENAW COUNTIES:		
GROUP 1.....	\$ 25.20	13.15
GROUP 2.....	\$ 24.91	12.95
GROUP 3.....	\$ 25.03	12.95
GROUP 4.....	\$ 25.10	12.95
GROUP 5.....	\$ 25.25	12.95
GROUP 6.....	\$ 22.55	12.95
GROUP 7.....	\$ 19.19	12.95
ZONE 3 - CLINTON, EATON, GENESEE, HILLSDALE AND INGHAM COUNTIES; IONIA COUNTY (City of Portland); JACKSON, LAPEER AND LENAWEE COUNTIES; LIVINGSTON COUNTY (west of M-151 Oak Grove Rd.); SANILAC, ST. CLAIR AND SHIAWASSEE COUNTIES:		
GROUP 1.....	\$ 23.39	13.15
GROUP 2.....	\$ 23.13	12.95
GROUP 3.....	\$ 23.25	12.95
GROUP 4.....	\$ 23.30	12.95
GROUP 5.....	\$ 23.44	12.95
GROUP 6.....	\$ 20.74	12.95
GROUP 7.....	\$ 17.89	12.95
ZONE 4 - ALCONA, ALLEGAN, ALPENA, ANTRIM, ARENAC, BARRY, BAY, BENZIE, BERRIEN, BRANCH, CALHOUN, CASS, CHARLEVOIX, CHEBOYGAN, CLARE, CRAWFORD, EMMET, GLADWIN, GRAND TRAVERSE, GRATIOT AND HURON COUNTIES; IONIA COUNTY (EXCEPT THE CITY OF PORTLAND); IOSCO, ISABELLA, KALAMAZOO, KALKASKA, KENT, LAKE, LEELANAU, MANISTEE, MASON, MECOSTA, MIDLAND, MISSAUKEE, MONTCALM, MONTMORENCY, MUSKEGON, NEWAYGO, OCEANA, OGEMAW, OSCEOLA, OSCODA, OTSEGO, OTTAWA, PRESQUE ISLE, ROSCOMMON, SAGINAW, ST. JOSEPH, TUSCOLA, VAN BUREN AND WEXFORD COUNTIES:		
GROUP 1.....	\$ 22.42	12.95

GROUP 2.....	\$ 22.15	12.95
GROUP 3.....	\$ 22.26	12.95
GROUP 4.....	\$ 22.33	12.95
GROUP 5.....	\$ 22.45	12.95
GROUP 6.....	\$ 19.67	12.95
GROUP 7.....	\$ 18.01	12.95

ZONE 5 - ALGER, BARAGA,  
 CHIPPEWA, DELTA,  
 DICKINSON, GOGEBIC,  
 HOUGHTON, IRON,  
 KEWEENAW, LUCE, MACKINAC,  
 MARQUETTE, MENOMINEE,  
 ONTONAGON AND SCHOOLCRAFT  
 COUNTIES:

GROUP 1.....	\$ 22.24	12.95
GROUP 2.....	\$ 22.38	12.95
GROUP 3.....	\$ 22.51	12.95
GROUP 4.....	\$ 22.56	12.95
GROUP 5.....	\$ 22.64	13.41
GROUP 6.....	\$ 19.99	12.95
GROUP 7.....	\$ 18.10	12.95

SCOPE OF WORK:

Open cut construction work shall be construed to mean work which requires the excavation of earth including industrial, commercial and residential building site excavation and preparation, land balancing, demolition and removal of concrete and underground appurtenances, grading, paving, sewers, utilities and improvements; retention, oxidation, flocculation and irrigation facilities, and also including but not limited to underground piping, conduits, steel sheeting for underground construction, and all work incidental thereto, and general excavation. For all areas except the Upper Peninsula, open cut construction work shall also be construed to mean waterfront work, piers, docks, seawalls, breakwalls, marinas and all incidental work. Open cut construction work shall not include any structural modifications, alterations, additions and repairs to buildings, or highway work, including roads, streets, bridge construction and parking lots or steel erection work and excavation for the building itself and back filling inside of and within 5 ft. of the building and foundations, footings and piers for the building. Open cut construction work shall not include any work covered under Tunnel, Shaft and Caisson work.

OPEN CUT LABORER CLASSIFICATIONS

GROUP 1: Construction laborer

GROUP 2: Mortar and material mixer, concrete form person, signal person, well point person, manhole, headwall and catch basin builder, headwall, seawall, breakwall and dock builder

GROUP 3: Air, gasoline and electric tool operator, vibrator operator, driller, pump person, tar kettle operator, bracer, rodder, reinforced steel or mesh person (e.g., wire mesh, steel mats, dowel bars, etc.), welder, pipe jacking and boring person, wagon drill and air track operator and concrete saw operator (under 40 h.p.), windlass and tugger person and directional boring person

GROUP 4: Trench or excavating grade person

GROUP 5: Pipe layer (including crock, metal pipe, multi-plate or other conduits)

GROUP 6: Grouting man, audio-visual television operations and all other operations in connection with closed circuit television inspection, pipe cleaning and pipe relining work and the installation and repair of water service pipe and appurtenances

GROUP 7: Restoration laborer, seeding, sodding, planting, cutting, mulching and top soil grading; and the restoration of property such as replacing mailboxes, wood chips, planter boxes, flagstones, etc.

-----  
LAB00465-001 06/01/2022

LABORER: Highway, Bridge and Airport Construction

AREA 1: GENESEE, MACOMB, MONROE, OAKLAND, WASHTENAW AND WAYNE COUNTIES

AREA 2: ALLEGAN, BARRY, BAY, BERRIEN, BRANCH, CALHOUN, CASS, CLINTON, EATON, GRATIOT, HILLSDALE, HURON, INGHAM, JACKSON, KALAMAZOO, LAPEER, LENAWEE, LIVINGSTON, MIDLAND, MUSKEGON, SAGINAW, SANILAC, SHIAWASSEE, ST. CLAIR, ST. JOSEPH, TUSCOLA AND VAN BUREN COUNTIES

AREA 3: ALCONA, ALPENA, ANTRIM, ARENAC, BENZIE, CHARLEVOIX, CHEBOYGAN, CLARE, CRAWFORD, EMMET, GLADWIN, GRAND TRAVERSE, IONIA, IOSCO, ISABELLA, KALKASKA, KENT, LAKE, LEELANAU, MANISTEE, MASON, MECOSTA, MISSAUKEE, MONTCALM, MONTMORENCY, NEWAYGO, OCEANA, OGEMAW, OSCEOLA, OSCODA, OTSEGO, OTTAWA, PRESQUE ISLE, ROSCOMMON AND WEXFORD COUNTIES

AREA 4: ALGER, BARAGA, CHIPPEWA, DELTA, DICKINSON, GOGEBIC, HOUGHTON, IRON, KEWEENAW, LUCE, MACKINAC, MARQUETTE, MENOMINEE, ONTONAGON AND SCHOOLCRAFT COUNTIES

	Rates	Fringes
LABORER (AREA 1)		
GROUP 1.....	\$ 32.02	13.95
GROUP 2.....	\$ 32.15	13.95
GROUP 3.....	\$ 32.33	13.95
GROUP 4.....	\$ 32.41	13.95
GROUP 5.....	\$ 32.62	13.95
GROUP 6.....	\$ 32.92	13.95
LABORER (AREA 2)		
GROUP 1.....	\$ 26.92	12.90
GROUP 2.....	\$ 27.12	12.90
GROUP 3.....	\$ 27.36	12.90
GROUP 4.....	\$ 27.71	12.90
GROUP 5.....	\$ 27.58	12.90
GROUP 6.....	\$ 27.92	12.90
LABORER (AREA 3)		
GROUP 1.....	\$ 26.22	12.90
GROUP 2.....	\$ 26.43	12.90
GROUP 3.....	\$ 26.72	12.90
GROUP 4.....	\$ 27.16	12.90
GROUP 5.....	\$ 26.78	12.90
GROUP 6.....	\$ 27.21	12.90
LABORER (AREA 4)		

GROUP 1.....	\$ 26.22	12.90
GROUP 2.....	\$ 26.43	12.90
GROUP 3.....	\$ 26.72	12.90
GROUP 4.....	\$ 27.16	12.90
GROUP 5.....	\$ 26.78	12.90
GROUP 6.....	\$ 27.21	12.90

LABORER CLASSIFICATIONS

GROUP 1: Asphalt shoveler or loader; asphalt plant misc.; burlap person; yard person; dumper (wagon, truck, etc.); joint filling laborer; miscellaneous laborer; unskilled laborer; sprinkler laborer; form setting laborer; form stripper; pavement reinforcing; handling and placing (e.g., wire mesh, steel mats, dowel bars); mason's tender or bricklayer's tender on manholes; manhole builder; headwalls, etc.; waterproofing, (other than buildings) seal coating and slurry mix, shoring, underpinning; pressure grouting; bridge pin and hanger removal; material recycling laborer; horizontal paver laborer (brick, concrete, clay, stone and asphalt); ground stabilization and modification laborer; grouting; waterblasting; top person; railroad track and trestle laborer; carpenters' tender; guard rail builders' tender; earth retention barrier and wall and M.S.E. wall installer's tender; highway and median installer's tender (including sound, retaining, and crash barriers); fence erector's tender; asphalt raker tender; sign installer; remote control operated equipment.

GROUP 2: Mixer operator (less than 5 sacks); air or electric tool operator (jackhammer, etc.); spreader; boxperson (asphalt, stone, gravel); concrete paddler; power chain saw operator; paving batch truck dumper; tunnel mucker (highway work only); concrete saw (under 40 h.p.) and dry pack machine; roto-mill grounds person.

GROUP 3: Tunnel miner (highway work only); finishers tenders; guard rail builders; highway and median barrier installer; earth retention barrier and wall and M.S.E. wall installer's (including sound, retaining and crash barriers); fence erector; bottom person; powder person; wagon drill and air track operator; diamond and core drills; grade checker; certified welders; curb and side rail setter's tender.

GROUP 4: Asphalt raker

GROUP 5: Pipe layers, oxy-gun

GROUP 6: Line-form setter for curb or pavement; asphalt screed checker/screw man on asphalt paving machines.

-----  
LAB01076-005 04/01/2022

MICHIGAN STATEWIDE

	Rates	Fringes
LABORER (DISTRIBUTION WORK)		
Zone 1.....	\$ 25.17	13.32
Zone 2.....	\$ 23.47	13.40
Zone 3.....	\$ 21.60	13.45
Zone 4.....	\$ 20.97	13.43
Zone 5.....	\$ 21.00	13.40



DISTRIBUTION WORK - The construction, installation, treating and reconditioning of distribution pipelines transporting coal, oil, gas or other similar materials, vapors or liquids, including pipelines within private property boundaries, up to and including the meter settings on residential, commercial, industrial, institutional, private and public structures. All work covering pumping stations and tank farms not covered by the Building Trades Agreement. Other distribution lines with the exception of sewer, water and cable television are included.

Underground Duct Layer Pay: \$.40 per hour above the base pay rate.

Zone 1 - Macomb, Oakland and Wayne

Zone 2 - Monroe and Washtenaw

Zone 3 - Bay, Genesee, Lapeer, Midland, Saginaw, Sanilac, Shiawassee and St. Clair

Zone 4 - Alger, Baraga, Chippewa, Delta, Dickinson, Gogebic, Houghton, Iron, Keweenaw, Luce, Mackinac, Marquette, Menominee, Ontonagon and Schoolcraft

Zone 5 - Remaining Counties in Michigan

-----  
 PAIN0022-002 07/01/2008

HILLSDALE, JACKSON AND LENAWEE COUNTIES; LIVINGSTON COUNTY (east of the eastern city limits of Howell, not including the city of Howell, north to the Genesee County line and south to the Washtenaw County line); MACOMB, MONROE, OAKLAND, WASHTENAW AND WAYNE COUNTIES:

	Rates	Fringes
PAINTER.....	\$ 25.06	14.75

FOOTNOTES: For all spray work and journeyman rigging for spray work, also blowing off, \$0.80 per hour additional (applies only to workers doing rigging for spray work on off the floor work. Does not include setting up or moving rigging on floor surfaces, nor does it apply to workers engaged in covering up or tending spray equipment. For all sandblasting and spray work performed on highway bridges, overpasses, tanks or steel, \$0.80 per hour additional. For all brushing, cleaning and other preparatory work (other than spraying or steeplejack work) at scaffold heights of fifty (50) feet from the ground or higher, \$0.50 per hour additional. For all preparatorial work and painting performed on open steel under forty (40) feet when no scaffolding is involved, \$0.50 per hour additional. For all swing stage work-window jacks and window belts-exterior and interior, \$0.50 per hour additional. For all spray work and sandblaster work to a scaffold height of forty (40) feet above the floor level, \$0.80 per hour additional. For all preparatorial work and painting on all highway bridges or overpasses up to forty (40) feet in height, \$0.50 per hour additional. For all steeplejack work performed where the elevation is forty (40) feet or more, \$1.25 per hour additional.

-----  
 PAIN0312-001 06/01/2018

EXCLUDES: ALLEGAN COUNTY (Townships of Dorr, Fillmore, Heath, Hopkins, Laketown, Leighton, Manlius, Monterey, Overisel, Salem, Saugatuck and Wayland); INCLUDES: Barry, Berrien, Branch, Calhoun, Cass, Hillsdale, Kalamazoo, St. Joseph, Van Buren

	Rates	Fringes
PAINTER		
Brush and roller.....	\$ 23.74	13.35
Spray, Sandblast, Sign		
Painting.....	\$ 24.94	13.35

-----  
 PAIN0845-003 05/10/2018

CLINTON COUNTY; EATON COUNTY (does not include the townships of Bellevue and Olivet); INGHAM COUNTY; IONIA COUNTY (east of Hwy. M 66); LIVINGSTON COUNTY (west of the eastern city limits of Howell, including the city of Howell, north to the Genesee County line and south to the Washtenaw County line); AND SHIAWASSEE COUNTY (Townships of Bennington, Laingsbury and Perry):

	Rates	Fringes
PAINTER.....	\$ 25.49	13.74

-----  
 PAIN0845-015 05/10/2018

MUSKEGON COUNTY; NEWAYGO COUNTY (except the Townships of Barton, Big Prairie, Brooks, Croton, Ensley, Everett, Goodwell, Grant, Home, Monroe, Norwich and Wilcox); OCEANA COUNTY; OTTAWA COUNTY (except the townships of Allendale, Blendone, Chester, Georgetown, Holland, Jamestown, Olive, Park, Polkton, Port Sheldon, Tallmadge, Wright and Zeeland):

	Rates	Fringes
PAINTER.....	\$ 25.49	13.74

-----  
 PAIN0845-018 05/10/2018

ALLEGAN COUNTY (Townships of Dorr, Fillmore, Heath, Hopkins, Laketown, Leighton, Manlius, Monterey, Overisel, Salem, Saugatuck and Wayland); IONIA COUNTY (west of Hwy. M-66); KENT, MECOSTA AND MONTCALM COUNTIES; NEWAYGO COUNTY (Townships of Barton, Big Prairie, Brooks, Croton, Ensley, Everett, Goodwell, Grant, Home, Monroe, Norwich and Wilcox); OSCEOLA COUNTY (south of Hwy. #10); OTTAWA COUNTY (Townships of Allendale, Blendone, Chester, Georgetown, Holland, Jamestown, Olive, Park, Polkton, Port Sheldon, Tallmadge, Wright and Zeeland):

	Rates	Fringes
PAINTER.....	\$ 25.49	13.74

FOOTNOTES: Lead abatement work: \$1.00 per hour additional.

-----  
 PAIN1011-003 06/02/2022

ALGER, BARAGA, CHIPPEWA, DELTA, DICKINSON, GOGEBIC, HOUGHTON,

IRON, KEWEENAW, LUCE, MACKINAC, MARQUETTE, MENOMINEE, ONTONAGON  
AND SCHOOLCRAFT COUNTIES:

	Rates	Fringes
PAINTER.....	\$ 24.66	14.99

FOOTNOTES: High pay (bridges, overpasses, watertower): 30 to 80 ft.: \$.65 per hour additional. 80 ft. and over: \$1.30 per hour additional.

-----  
PAIN1474-002 06/01/2010

HURON COUNTY; LAPEER COUNTY (east of Hwy. M-53); ST. CLAIR,  
SANILAC AND TUSCOLA COUNTIES:

	Rates	Fringes
PAINTER.....	\$ 23.79	12.02

FOOTNOTES: Lead abatement work: \$1.00 per hour additional. Work with any hazardous material: \$1.00 per hour additional. Sandblasting, steam cleaning and acid cleaning: \$1.00 per hour additional. Ladder work at or above 40 ft., scaffold work at or above 40 ft., swing stage, boatswain chair, window jacks and all work performed over a falling height of 40 ft.: \$1.00 per hour additional. Spray gun work, pick pullers and those handling needles, blowing off by air pressure, and any person rigging (setting up and moving off the ground): \$1.00 per hour additional. Steeplejack, tanks, gas holders, stacks, flag poles, radio towers and beacons, power line towers, bridges, etc.: \$1.00 per hour additional, paid from the ground up.

-----  
PAIN1803-003 06/01/2019

ALCONA, ALPENA, ANTRIM, ARENAC, BAY, BENZIE, CHARLEVOIX,  
CHEBOYGAN, CLARE, CRAWFORD, EMMET, GLADWIN, GRAND TRAVERSE,  
GRATIOT, IOSCO, ISABELLA, KALKASKA, LAKE, LEELANAU, MANISTEE,  
MASON, MIDLAND, MISSAUKEE, MONTMORENCY AND OGEMAW COUNTIES;  
OSCEOLA COUNTY (north of Hwy. #10); OSCODA, OTSEGO, PRESQUE  
ISLE, ROSCOMMON, SAGINAW AND WEXFORD COUNTIES:

	Rates	Fringes
PAINTER Work performed on water, bridges over water or moving traffic, radio and powerline towers, elevated tanks, steeples, smoke stacks over 40 ft. of falling heights, recovery of lead-based paints and any work associated with industrial plants, except maintenance of industrial plants.....	\$ 25.39	14.68
All other work, including maintenance of industrial		

plant.....\$ 25.39 14.68

FOOTNOTES: Spray painting, sandblasting, blowdown associated with spraying and blasting, water blasting and work involving a swing stage, boatswain chair or spider: \$1.00 per hour additional. All work performed inside tanks, vessels, tank trailers, railroad cars, sewers, smoke stacks, boilers or other spaces having limited egress not including buildings, opentop tanks, pits, etc.: \$1.25 per hour additional.

-----  
PLAS0514-001 06/01/2018

ZONE 1: GENESEE, LIVINGSTON, MACOMB, MONROE, OAKLAND, SAGINAW, WASHTENAW AND WAYNE COUNTIES

ZONE 2: ALCONA, ALGER, ALLEGAN, ALPENA, ANTRIM, ARENAC, BARAGA, BARRY, BAY, BENZIE, BERRIEN, BRANCH, CALHOUN, CASS, CHARLEVOIX, CHEBOYGAN, CHIPPEWA, CLARE, CLINTON, CRAWFORD, DELTA, DICKINSON, EATON, EMMET, GLADWIN, GOGEBIC, GRAND TRAVERSE, GRATIOT, HILLSDALE, HOUGHTON, HURON, INGHAM, IONIA, IOSCO, IRON, ISABELLA, JACKSON, KALAMAZOO, KALKASKA, KENT, KEWEENAW, LAKE, LAPEER, LEELANAU, LENAWEE, LUCE, MACKINAC, MANISTEE, MARQUETTE, MASON, MECOSTA, MENOMINEE, MIDLAND, MISSAUKEE, MONTCALM, MONTMORENCY, MUSKEGON, NEWAYGO, OCEANA, OGEMAW, ONTONAGON, OSCEOLA, OSCODA, OTSEGO, OTTAWA, PRESQUE ISLE, ROSCOMMON, SANILAC, SCHOOLCRAFT, SHIAWASSEE, ST. CLAIR, ST. JOSEPH, TUSCOLA, VAN BUREN AND WEXFORD COUNTIES

	Rates	Fringes
CEMENT MASON/CONCRETE FINISHER		
ZONE 1.....	\$ 31.47	13.81
ZONE 2.....	\$ 29.97	13.81

-----  
PLUM0190-003 05/01/2015

ALCONA, ALGER, ALLEGAN, ALPENA, ANTRIM, ARENAC, BARAGA, BARRY, BAY, BENZIE, BERRIEN, BRANCH, CALHOUN, CASS, CHARLEVOIX, CHEBOYGAN, CHIPPEWA, CLARE, CLINTON, CRAWFORD, DELTA, DICKINSON, EATON, EMMET, GENESEE, GLADWIN, GOGEBIC, GRAND TRAVERSE, GRATIOT, HILLSDALE, HOUGHTON, HURON, INGHAM, IONIA, IOSCO, IRON, ISABELLA, JACKSON, KALAMAZOO, KALKASKA, KENT, KEWEENAW, LAKE, LAPEER, LEELANAU, LENAWEE, LIVINGSTON, LUCE, MACKINAC, MACOMB, MANISTEE, MARQUETTE, MASON, MECOSTA, MENOMINEE, MIDLAND, MISSAUKEE, MONTCALM, MONTMORENCY, MONROE, MUSKEGON, NEWAYGO, OAKLAND, OCEANA, OGEMAW, ONTONAGON, OSCEOLA, OSCODA, OTSEGO, OTTAWA, PRESQUE ISLE, ROSCOMMON, SAGINAW, ST. CLARE, ST. JOSEPH, SANILAC, SCHOOLCRAFT, SHIAWASSEE, TUSCOLA, VAN BUREN, WASHTENAW, WAYNE AND WEXFORD COUNTIES

	Rates	Fringes
Plumber/Pipefitter - gas distribution pipeline:		
Welding in conjunction with gas distribution pipeline work.....	\$ 33.03	20.19
All other work:.....	\$ 24.19	12.28

-----  
TEAM0007-004 06/01/2020

AREA 1: ALCONA, ALGER, ALLEGAN, ALPENA, ANTRIM, ARENAC, BARAGA, BARRY, BAY, BENZIE, BERRIEN, BRANCH, CALHOUN, CASS, CHARLEVOIX, CHEBOYGAN, CHIPPEWA, CLARE, CLINTON, CRAWFORD, DELTA, DICKINSON, EATON, EMMET, GLADWIN, GOGEBIC, GRAND TRAVERSE, GRATIOT, HILLSDALE, HOUGHTON, HURON, INGHAM, IONIA, IOSCO, IRON, ISABELLA, JACKSON, KALAMAZOO, KALKASKA, KENT, KEWEENAW, LAKE, LAPEER, LEELANAU, LENAWEE, LUCE, MACKINAC, MANISTEE, MARQUETTE, MASON, MECOSTA, MENOMINEE, MIDLAND, MISSAUKEE, MONTCALM, MONTMORENCY, MUSKEGON, NEWAYGO, OCEANA, OGEMAW, ONTONAGON, OSCEOLA, OSCODA, OTSEGO, OTTAWA, PRESQUE ISLE, ROSCOMMON, SAGINAW, SANILAC, SCHOOLCRAFT, SHIAWASSEE, ST. CLAIR, ST. JOSEPH, TUSCOLA, VAN BUREN AND WEXFORD COUNTIES

AREA 2: GENESEE, LIVINGSTON, MACOMB, MONROE, OAKLAND, WASHTENAW AND WAYNE COUNTIES

	Rates	Fringes
TRUCK DRIVER		
AREA 1		
Euclids, double bottoms and lowboys.....	\$ 28.05	.50 + a+b
Trucks under 8 cu. yds.....	\$ 27.80	.50 + a+b
Trucks, 8 cu. yds. and over.....	\$ 27.90	.50 + a+b
AREA 2		
Euclids, double bottomms and lowboys.....	\$ 24.895	.50 + a+b
Euclids, double bottoms and lowboys.....	\$ 28.15	.50 + a+b
Trucks under 8 cu. yds.....	\$ 27.90	.50 + a+b
Trucks, 8 cu. yds. and over.....	\$ 28.00	.50 + a+b

Footnote:

- a. \$470.70 per week
- b. \$68.70 daily

-----  
TEAM0247-004 04/01/2013

AREA 1: ALCONA, ALGER, ALLEGAN, ALPENA, ANTRIM, ARENAC, BARAGA, BARRY, BAY, BENZIE, BERRIEN, BRANCH, CALHOUN, CASS, CHARLEVOIX, CHEBOYGAN, CHIPPEWA, CLARE, CLINTON, CRAWFORD, DELTA, DICKINSON, EATON, EMMET, GLADWIN, GOGEBIC, GRAND TRAVERSE, GRATIOT, HILLSDALE, HOUGHTON, HURON, INGHAM, IONIA, IOSCO, IRON, ISABELLA, JACKSON, KALAMAZOO, KALKASKA, KENT, KEWEENAW, LAKE, LAPEER, LEELANAU, LENAWEE, LUCE, MACKINAC, MANISTEE, MARQUETTE, MASON, MECOSTA, MENOMINEE, MIDLAND, MISSAUKEE, MONTCALM, MONTMORENCY, MUSKEGON, NEWAYGO, OCEANA, OGEMAW, ONTONAGON, OSCEOLA, OSCODA, OTSEGO, OTTAWA, PRESQUE ISLE, ROSCOMMON, SANILAC, SCHOOLCRAFT, SHIAWASSEE, SAGINAW, ST. CLAIR, ST. JOSEPH, TUSCOLA, VAN BUREN AND WEXFORD COUNTIES

AREA 2: GENESEE, LIVINGSTON, MACOMB, MONROE, OAKLAND, WASHTENAW AND WAYNE COUNTIES

	Rates	Fringes
Sign Installer		
AREA 1		
GROUP 1.....	\$ 21.78	11.83
GROUP 2.....	\$ 25.27	11.8375
AREA 2		

GROUP 1.....	\$ 22.03	11.83
GROUP 2.....	\$ 25.02	11.8375

FOOTNOTE:

a. \$132.70 per week, plus \$17.80 per day.

SIGN INSTALLER CLASSIFICATIONS:

GROUP 1: performs all necessary labor and uses all tools required to construct and set concrete forms required in the installation of highway and street signs

GROUP 2: performs all miscellaneous labor, uses all hand and power tools, and operates all other equipment, mobile or otherwise, required for the installation of highway and street signs

-----  
TEAM0247-010 04/01/2018

AREA 1: LAPEER AND SHIAWASSEE COUNTIES

AREA 2: GENESEE, MACOMB, MONROE, OAKLAND, ST. CLAIR, WASHTENAW AND WAYNE COUNTIES

	Rates	Fringes
TRUCK DRIVER (Underground construction)		
AREA 1		
GROUP 1.....	\$ 23.82	19.04
GROUP 2.....	\$ 23.91	19.04
GROUP 3.....	\$ 24.12	19.04
AREA 2		
GROUP 1.....	\$ 24.12	19.04
GROUP 2.....	\$ 24.26	19.04
GROUP 3.....	\$ 24.45	19.04

PAID HOLIDAYS: New Year's Day, Memorial Day, Fourth of July, Labor Day, Thanksgiving Day and Christmas Day.

SCOPE OF WORK: Excavation, site preparation, land balancing, grading, sewers, utilities and improvements; also including but not limited to, tunnels, underground piping, retention, oxidation, flocculation facilities, conduits, general excavation and steel sheeting for underground construction. Underground construction work shall not include any structural modifications, alterations, additions and repairs to buildings or highway work, including roads, streets, bridge construction and parking lots or steel erection.

TRUCK DRIVER CLASSIFICATIONS

GROUP 1: Truck driver on all trucks (EXCEPT dump trucks of 8 cubic yards capacity or over, pole trailers, semis, low boys, Euclid, double bottom and fuel trucks)

GROUP 2: Truck driver on dump trucks of 8 cubic yards capacity or over, pole trailers, semis and fuel trucks

GROUP 3: Truck driver on low boy, Euclid and double bottom

-----  
\* SUMI2002-001 05/01/2002

	Rates	Fringes
Flag Person.....	\$ 10.10 **	0.00
LINE PROTECTOR (ZONE 1: GENESEE, MACOMB, MONROE, OAKLAND, WASHTENAW AND WAYNE)....	\$ 22.89	13.45
LINE PROTECTOR (ZONE 2: STATEWIDE (EXCLUDING GENESEE, MACOMB, MONROE, OAKLAND, WASHTENAW AND WAYNE).....	\$ 20.19	13.45
Pavement Marking Machine (ZONE 1: GENESEE, MACOMB, MONROE, OAKLAND, WASHTENAW AND WAYNE COUNTIES) Group 1.....	\$ 30.52	13.45
Pavement Marking Machine (ZONE 1: GENESEE, MACOMB, MONROE, OAKLAND, WASHTENAW AND WAYNE) Group 2.....	\$ 27.47	13.45
Pavement Marking Machine (ZONE 2: STATEWIDE (EXCLUDING GENESEE, MACOMB, MONROE, OAKLAND, WASHTENAW AND WAYNE COUNTIES) Group 1.....	\$ 26.92	13.45
Pavement Marking Machine (ZONE 2: STATEWIDE (EXCLUDING GENESEE, MACOMB, MONROE, OAKLAND, WASHTENAW AND WAYNE) Group 2.....	\$ 24.23	13.45

WORK CLASSIFICATIONS:

PAVEMENT MARKER GROUP 1: Drives or operates a truck mounted striper, grinder, blaster, groover, or thermoplastic melter for the placement or removal of temporary or permanent pavement markings or markers.

PAVEMENT MARKER GROUP 2: Performs all functions involved for the placement or removal of temporary or permanent pavement markings or markers not covered by the classification of Pavement Marker Group 1 or Line Protector.

LINE PROTECTOR: Performs all operations for the protection or removal of temporary or permanent pavement markings or markers in a moving convoy operation not performed by the classification of Pavement Marker Group 1. A moving convoy operation is comprised of only Pavement Markers Group 1 and Line Protectors.

-----  
WELDERS - Receive rate prescribed for craft performing operation to which welding is incidental.

\*\*\*\*\*  
\*\* Workers in this classification may be entitled to a higher minimum wage under Executive Order 14026 (\$16.20) or 13658 (\$12.15). Please see the Note at the top of the wage determination for more information.

Note: Executive Order (EO) 13706, Establishing Paid Sick Leave for Federal Contractors applies to all contracts subject to the Davis-Bacon Act for which the contract is awarded (and any solicitation was issued) on or after January 1, 2017. If this contract is covered by the EO, the contractor must provide employees with 1 hour of paid sick leave for every 30 hours they work, up to 56 hours of paid sick leave each year. Employees must be permitted to use paid sick leave for their own illness, injury or other health-related needs, including preventive care; to assist a family member (or person who is like family to the employee) who is ill, injured, or has other health-related needs, including preventive care; or for reasons resulting from, or to assist a family member (or person who is like family to the employee) who is a victim of, domestic violence, sexual assault, or stalking. Additional information on contractor requirements and worker protections under the EO is available at <https://www.dol.gov/agencies/whd/government-contracts>.

Unlisted classifications needed for work not included within the scope of the classifications listed may be added after award only as provided in the labor standards contract clauses (29CFR 5.5 (a) (1) (ii)).

-----  
The body of each wage determination lists the classification and wage rates that have been found to be prevailing for the cited type(s) of construction in the area covered by the wage determination. The classifications are listed in alphabetical order of ""identifiers"" that indicate whether the particular rate is a union rate (current union negotiated rate for local), a survey rate (weighted average rate) or a union average rate (weighted union average rate).

#### Union Rate Identifiers

A four letter classification abbreviation identifier enclosed in dotted lines beginning with characters other than ""SU"" or ""UAVG"" denotes that the union classification and rate were prevailing for that classification in the survey. Example: PLUM0198-005 07/01/2014. PLUM is an abbreviation identifier of the union which prevailed in the survey for this classification, which in this example would be Plumbers. 0198 indicates the local union number or district council number where applicable, i.e., Plumbers Local 0198. The next number, 005 in the example, is an internal number used in processing the wage determination. 07/01/2014 is the effective date of the most current negotiated rate, which in this example is July 1, 2014.

Union prevailing wage rates are updated to reflect all rate changes in the collective bargaining agreement (CBA) governing this classification and rate.



## Survey Rate Identifiers

Classifications listed under the "SU" identifier indicate that no one rate prevailed for this classification in the survey and the published rate is derived by computing a weighted average rate based on all the rates reported in the survey for that classification. As this weighted average rate includes all rates reported in the survey, it may include both union and non-union rates. Example: SULA2012-007 5/13/2014. SU indicates the rates are survey rates based on a weighted average calculation of rates and are not majority rates. LA indicates the State of Louisiana. 2012 is the year of survey on which these classifications and rates are based. The next number, 007 in the example, is an internal number used in producing the wage determination. 5/13/2014 indicates the survey completion date for the classifications and rates under that identifier.

Survey wage rates are not updated and remain in effect until a new survey is conducted.

## Union Average Rate Identifiers

Classification(s) listed under the UAVG identifier indicate that no single majority rate prevailed for those classifications; however, 100% of the data reported for the classifications was union data. EXAMPLE: UAVG-OH-0010 08/29/2014. UAVG indicates that the rate is a weighted union average rate. OH indicates the state. The next number, 0010 in the example, is an internal number used in producing the wage determination. 08/29/2014 indicates the survey completion date for the classifications and rates under that identifier.

A UAVG rate will be updated once a year, usually in January of each year, to reflect a weighted average of the current negotiated/CBA rate of the union locals from which the rate is based.

---

## WAGE DETERMINATION APPEALS PROCESS

1.) Has there been an initial decision in the matter? This can be:

- \* an existing published wage determination
- \* a survey underlying a wage determination
- \* a Wage and Hour Division letter setting forth a position on a wage determination matter
- \* a conformance (additional classification and rate) ruling

On survey related matters, initial contact, including requests for summaries of surveys, should be with the Wage and Hour National Office because National Office has responsibility for the Davis-Bacon survey program. If the response from this initial contact is not satisfactory, then the process described in 2.) and 3.) should be followed.

With regard to any other matter not yet ripe for the formal process described here, initial contact should be with the Branch of Construction Wage Determinations. Write to:

Branch of Construction Wage Determinations  
Wage and Hour Division

U.S. Department of Labor  
200 Constitution Avenue, N.W.  
Washington, DC 20210

2.) If the answer to the question in 1.) is yes, then an interested party (those affected by the action) can request review and reconsideration from the Wage and Hour Administrator (See 29 CFR Part 1.8 and 29 CFR Part 7). Write to:

Wage and Hour Administrator  
U.S. Department of Labor  
200 Constitution Avenue, N.W.  
Washington, DC 20210

The request should be accompanied by a full statement of the interested party's position and by any information (wage payment data, project description, area practice material, etc.) that the requestor considers relevant to the issue.

3.) If the decision of the Administrator is not favorable, an interested party may appeal directly to the Administrative Review Board (formerly the Wage Appeals Board). Write to:

Administrative Review Board  
U.S. Department of Labor  
200 Constitution Avenue, N.W.  
Washington, DC 20210

4.) All decisions by the Administrative Review Board are final.

=====

END OF GENERAL DECISIO"

Superseded General Decision Number: MI20220044

State: Michigan

Construction Type: Heavy

Counties: Arenac, Branch, Gladwin, Hillsdale, Huron, Lenawee, Mecosta, Midland, Osceola, Shiawassee and Tuscola Counties in Michigan.

Heavy, Includes Water, Sewer Lines and Excavation (Excludes Hazardous Waste Removal; Coal, Oil, Gas, Duct and other similar Pipeline Construction)

Note: Contracts subject to the Davis-Bacon Act are generally required to pay at least the applicable minimum wage rate required under Executive Order 14026 or Executive Order 13658. Please note that these Executive Orders apply to covered contracts entered into by the federal government that are subject to the Davis-Bacon Act itself, but do not apply to contracts subject only to the Davis-Bacon Related Acts, including those set forth at 29 CFR 5.1(a)(2)-(60).

If the contract is entered into on or after January 30, 2022, or the contract is renewed or extended (e.g., an option is exercised) on or after January 30, 2022:	. Executive Order 14026 generally applies to the contract. . The contractor must pay all covered workers at least \$16.20 per hour (or the applicable wage rate listed on this wage determination, if it is higher) for all hours spent performing on the contract in 2023.
If the contract was awarded on or between January 1, 2015 and January 29, 2022, and the contract is not renewed or extended on or after January 30, 2022:	. Executive Order 13658 generally applies to the contract. . The contractor must pay all covered workers at least \$12.15 per hour (or the applicable wage rate listed on this wage determination, if it is higher) for all hours spent performing on that contract in 2023.

The applicable Executive Order minimum wage rate will be adjusted annually. If this contract is covered by one of the Executive Orders and a classification considered necessary for performance of work on the contract does not appear on this wage determination, the contractor must still submit a conformance request.

Additional information on contractor requirements and worker protections under the Executive Orders is available at <http://www.dol.gov/whd/govcontracts>.

Modification Number	Publication Date
0	01/06/2023
1	02/03/2023
2	02/17/2023

CARP0100-005 06/01/2021

MECOSTA & OSCEOLA COUNTIES

	Rates	Fringes
CARPENTER (Form Work Only).....	\$ 25.24	20.31

-----  
 CARP0525-008 06/01/2021

BRANCH & HILLSDALE COUNTIES

	Rates	Fringes
CARPENTER (Form Work Only).....	\$ 25.94	20.59

-----  
 CARP0706-014 06/01/2020

ARENAC, GLADWIN, HURON, MIDLAND & TUSCOLA COUNTIES

	Rates	Fringes
CARPENTER (Form Work Only).....	\$ 27.61	21.84

-----  
 CARP0706-018 06/01/2021

SHIAWASSEE COUNTY

	Rates	Fringes
CARPENTER (Form Work Only).....	\$ 29.48	22.00

-----  
 CARP1004-013 06/01/2021

LENAWEE COUNTY

	Rates	Fringes
CARPENTER (Form Work Only).....	\$ 27.39	20.73

-----  
 ELEC0008-012 05/25/2022

HILLSDALE & LENAWE COUNTY

	Rates	Fringes
ELECTRICIAN.....	\$ 44.79	1.5%+15.61

-----  
 ELEC0058-008 06/28/2022

HURON COUNTY

	Rates	Fringes
ELECTRICIAN.....	\$ 48.52	26.11

-----  
 ELEC0275-009 06/01/2021

MECOSTA COUNTY

	Rates	Fringes
ELECTRICIAN.....	\$ 33.06	8.94+38%
-----		
ELEC0275-014 06/01/2022		

OSCEOLA COUNTY (Townships of Richmond, Hersey, Evert & Orient)

	Rates	Fringes
ELECTRICIAN.....	\$ 34.41	9.27+28%
-----		
ELEC0445-008 06/01/2022		

BRANCH COUNTY

	Rates	Fringes
ELECTRICIAN.....	\$ 35.40	23.29
-----		
ELEC0498-012 06/01/2022		

OSCEOLA COUNTY (does not include the townships of Evert, Hersey, Orient and Richmond)

	Rates	Fringes
ELECTRICIAN.....	\$ 33.44	21.05
-----		
ELEC0557-008 06/01/2020		

MIDLAND (Townships of Ingersoll, Jasper, Mount Haley and Porter) & TUSCOLA (Townships of Almer, Arbela, Columbia, Dayton, Denmark, Elkland, Ellington, Elmwood, Fairgrove, Fremont, Gilford, Indianfields, Juniata, Kingston, Koylon, Novesta, Tuscola, Vassar, Watertown and Wells) COUNTIES

	Rates	Fringes
ELECTRICIAN.....	\$ 34.25	23.13
-----		
ELEC0665-018 05/31/2021		

SHIAWASSEE COUNTY (Townships of Perry & Woodhull)

	Rates	Fringes
ELECTRICIAN.....	\$ 37.50	24.04+5.5%
-----		
ELEC0692-017 06/01/2022		

ARENAC & GLADWIN COUNTIES

	Rates	Fringes
ELECTRICIAN.....	\$ 35.31	38.03%+9.25
-----		
ELEC0692-018 06/01/2022		

MIDLAND (All townships except Mount Haley, Jasper, Porter & Ingersoll) & TUSCOLA (Townships of Wisner & Akron) COUNTIES

	Rates	Fringes
ELECTRICIAN.....	\$ 35.31	38.03%+9.25
-----		
ELEC0948-008 06/01/2020		

SHIAWASSEE (All townships except Perry & Woodhull) & TUSCOLA  
(Township of Millington) COUNTIES

	Rates	Fringes
ELECTRICIAN.....	\$ 39.17	23.51
-----		
ENGI0325-021 09/01/2022		

POWER EQUIPMENT OPERATORS: Underground Construction (Including  
Sewer)

	Rates	Fringes
POWER EQUIPMENT OPERATOR		
GROUP 1.....	\$ 37.67	24.85
GROUP 2.....	\$ 32.78	24.85
GROUP 3.....	\$ 32.28	24.85
GROUP 4.....	\$ 32.00	24.85

POWER EQUIPMENT OPERATOR CLASSIFICATIONS

GROUP 1: Backhoe/ Excavator, Boring Machine, Bulldozer,  
Crane, Scraper, Loader, Trencher (over 8 ft. digging  
capacity)

GROUP 2: Trencher (8-ft digging capacity and smaller)

GROUP 3: Boom Truck (non-swinging, non- powered type boom)

GROUP 4: Broom/ Sweeper, Fork Truck, Tractor

-----  
\* ENGI0326-014 06/01/2022

EXCLUDES UNDERGROUND CONSTRUCTION

AREA 1: BRANCH, HILLSDALE, MECOSTA & OSCEOLA COUNTIES

AREA 2: ARENAC, GLADWIN, HURON, MIDLAND, SHIAWASSEE & TUSCOLA  
COUNTIES

	Rates	Fringes
Operating Engineer:		
AREA 1		
Group 1.....	\$ 44.13	24.85
Group 2.....	\$ 40.83	24.85
Group 3.....	\$ 38.18	24.85
Group 4.....	\$ 36.47	24.85
Group 5.....	\$ 28.13	24.85
Operating Engineers:		
AREA 2		
Group 1.....	\$ 44.13	24.85
Group 2.....	\$ 40.83	24.85

Group 3.....	\$ 38.18	24.85
Group 4.....	\$ 36.47	24.85
Group 5.....	\$ 28.13	24.85

FOOTNOTES:

Crane operator with main boom and jib 300' or longer: \$1.50 per hour above the group 1 rate.  
 Crane operator with main boom and jib 400' or longer: \$3.00 per hour above the group 1 rate.

PAID HOLIDAYS: New Year's Day, Memorial Day, Fourth of July, Labor Day, Thanksgiving Day and Christmas Day.

POWER EQUIPMENT OPERATOR CLASSIFICATIONS

GROUP 1: Crane operator with main boom and jib 400', 300', or 220' or longer.

GROUP 2: Crane operator with main boom and jib 140' or longer, tower crane, gantry crane, whirley derrick

GROUP 3: Backhoe/Excavator; Bulldozer; Compactor; Crane; Scraper; Loader

GROUP 4: Boom truck (non-swinging)

GROUP 5: Oiler

-----  
 ENGI0326-024 06/01/2022

EXCLUDES UNDERGROUND CONSTRUCTION

LENAWEE COUNTY

	Rates	Fringes
OPERATOR: Power Equipment		
GROUP 1.....	\$ 46.44	24.95
GROUP 2.....	\$ 44.94	24.95
GROUP 3.....	\$ 43.44	24.95
GROUP 4.....	\$ 43.14	24.95
GROUP 5.....	\$ 42.32	24.95
GROUP 6.....	\$ 41.46	24.95
GROUP 7.....	\$ 40.49	24.95
GROUP 8.....	\$ 38.78	24.95

FOOTNOTES: Tower cranes: to be paid the crane operator rate determined by the combined length of the mast and the boom.

POWER EQUIPMENT OPERATOR CLASSIFICATIONS

GROUP 1: Crane with boom & jib or leads 400' or longer

GROUP 2: Crane with boom & jib or leads 300' or longer

GROUP 3: Crane with boom & jib or leads 220' or longer

GROUP 4: Crane with boom & jib or leads 140' or longer

GROUP 5: Crane with boom & jib or leads 120' or longer

GROUP 6: Regular crane operator

GROUP 7: Backhoe/Excavator, Bulldozer, Compactor, Scraper, Loader

GROUP 8: Oiler

-----  
IRON0025-007 06/01/2022

ARENAC, GLADWIN, HURON, MIDLAND, SHIAWASSEE & TUSCOLA COUNTIES

	Rates	Fringes
IRONWORKER		
Reinforcing.....	\$ 31.43	34.77
Structural.....	\$ 34.50	38.44

-----  
IRON0025-016 06/01/2022

BRANCH, HILLSDALE, MECOSTA & OSCEOLA COUNTIES

	Rates	Fringes
IRONWORKER (REINFORCING).....	\$ 31.43	34.77
IRONWORKER (STRUCTURAL).....	\$ 34.50	38.44

-----  
IRON0055-011 07/01/2022

LENAWEE COUNTY

	Rates	Fringes
IRONWORKER, STRUCTURAL AND REINFORCING.....	\$ 33.00	27.20

-----  
\* LABO0334-008 09/01/2022

SCOPE OF WORK:  
OPEN CUT CONSTRUCTION: Excavation of earth and sewer, utilities, and improvements, including underground piping/conduit (including inspection, cleaning, restoration, and relining)

ARENAC, BRANCH, GLADWIN, HURON, MECOSTA, MIDLAND, OSCEOLA, TUSCOLA

	Rates	Fringes
LABORER		
(1) Common or General.....	\$ 22.42	12.95
(4) Grade Checker.....	\$ 22.73	12.95

-----  
\* LABO0334-019 09/01/2022

SCOPE OF WORK:  
OPEN CUT CONSTRUCTION: Excavation of earth and sewer, utilities, and improvements, including underground piping/conduit (including inspection, cleaning, restoration, and relining)

HILLSDALE, LENAWE, SHIAWASSEE

	Rates	Fringes
--	-------	---------



LABORER  
 (1) Common or General.....\$ 23.39                   13.15  
 (4) Grade Checker.....\$ 23.70                   13.15

-----  
 LAB00355-007 06/01/2022

EXCLUDES OPEN CUT CONSTRUCTION

BRANCH COUNTY

Rates                   Fringes

LABORER  
 Common or General.....\$ 26.70                   12.95

-----  
 LAB00355-015 06/01/2022

EXCLUDES OPEN CUT CONSTRUCTION

MECOSTA & OSCEOLA COUNTIES

Rates                   Fringes

LABORER  
 Common or General.....\$ 26.70                   12.95

-----  
 LAB00499-014 06/01/2022

EXCLUDES OPEN CUT CONSTRUCTION

HILLSDALE & LENAWEE COUNTIES

Rates                   Fringes

LABORER  
 Common or General.....\$ 27.45                   13.20

-----  
 LAB01075-011 06/01/2022

EXCLUDES OPEN CUT CONSTRUCTION

SHIAWASSEE COUNTY

Rates                   Fringes

LABORER  
 Common or General.....\$ 26.41                   14.05

-----  
 LAB01098-022 07/01/2022

EXCLUDES OPEN CUT CONSTRUCTION

ARENAC, GLADWIN, HURON, MIDLAND & TUSCOLA COUNTIES

Rates                   Fringes

LABORER  
 Common or General.....\$ 23.44                   12.95

-----  
 PLAS0016-009 04/01/2014

MECOSTA & OSCEOLA COUNTIES

Rates                   Fringes

CEMENT MASON/CONCRETE FINISHER...\$ 22.02	12.38
-----	
PLAS0016-021 04/01/2014	
SHIAWASSEE COUNTY	
	Rates                      Fringes
CEMENT MASON/CONCRETE FINISHER...\$ 25.58	12.88
-----	
PLAS0016-023 04/01/2014	
BRANCH COUNTY	
	Rates                      Fringes
CEMENT MASON/CONCRETE FINISHER...\$ 24.63	12.88
-----	
PLAS0016-031 04/01/2014	
ARENAC, GLADWIN, HURON, MIDLAND & TUSCOLA COUNTIES	
	Rates                      Fringes
CEMENT MASON/CONCRETE FINISHER...\$ 25.47	12.38
-----	
PLAS0886-013 08/01/2011	
HILLSDALE & LENAWEЕ COUNTIES	
	Rates                      Fringes
CEMENT MASON/CONCRETE FINISHER...\$ 27.19	16.00
-----	
PLUM0085-017 05/04/2020	
ARENAC, GLADWIN, HURON (West of M-53), MIDLAND & TUSCOLA COUNTIES	
	Rates                      Fringes
PLUMBER/PIPEFITTER.....\$ 38.25	21.07
-----	
PLUM0098-008 06/01/2019	
HURON COUNTY (East of M-53)	
	Rates                      Fringes
PLUMBER.....\$ 35.77	35.13
-----	
PLUM0174-015 07/01/2020	
MECOSTA & OSCEOLA COUNTIES	
	Rates                      Fringes
PLUMBER/PIPEFITTER.....\$ 39.89	23.82
-----	
PLUM0190-012 06/01/2021	
LENAWEЕ COUNTY (Townships of Clinton, Macon & Tecumseh)	

	Rates	Fringes
PLUMBER/PIPEFITTER.....	\$ 44.31	23.70
-----		
* PLUM0333-021 06/01/2022		
BRANCH & HILLSDALE COUNTIES		
	Rates	Fringes
PLUMBER/PIPEFITTER.....	\$ 42.29	23.94
-----		
* PLUM0333-022 06/01/2022		
LENAWEE COUNTY (Remainder of County)		
	Rates	Fringes
PLUMBER/PIPEFITTER.....	\$ 42.29	23.94
-----		
PLUM0370-007 06/01/2020		
SHIAWASSEE COUNTY		
	Rates	Fringes
PLUMBER/PIPEFITTER.....	\$ 39.81	20.95
-----		
PLUM0636-008 06/05/2017		
HURON COUNTY (East of M-53)		
	Rates	Fringes
PIPEFITTER.....	\$ 40.41	29.35
-----		
TEAM0007-010 06/01/2020		
	Rates	Fringes
TRUCK DRIVER		
Lowboy/Semi-Trailer Truck...	\$ 28.15	.50 + a+b
FOOTNOTE:		
a. \$470.70 per week.		
b. \$68.70 daily.		
-----		
* SUMI2010-042 11/09/2010		
	Rates	Fringes
CARPENTER, Excludes Form Work....	\$ 23.97	6.29
LABORER: Landscape.....	\$ 10.89 **	1.74
LABORER: Mason Tender - Cement/Concrete.....	\$ 15.97 **	3.51
LABORER: Pipelayer.....	\$ 15.28 **	3.99
OPERATOR: Bobcat/Skid Steer/Skid Loader.....	\$ 12.98 **	6.12
OPERATOR: Grader/Blade.....	\$ 15.50 **	3.62

OPERATOR: Roller.....\$ 13.74 \*\* 7.93

TRUCK DRIVER: Dump Truck.....\$ 14.06 \*\* 1.25

-----  
WELDERS - Receive rate prescribed for craft performing operation to which welding is incidental.

=====  
\*\* Workers in this classification may be entitled to a higher minimum wage under Executive Order 14026 (\$16.20) or 13658 (\$12.15). Please see the Note at the top of the wage determination for more information.

Note: Executive Order (EO) 13706, Establishing Paid Sick Leave for Federal Contractors applies to all contracts subject to the Davis-Bacon Act for which the contract is awarded (and any solicitation was issued) on or after January 1, 2017. If this contract is covered by the EO, the contractor must provide employees with 1 hour of paid sick leave for every 30 hours they work, up to 56 hours of paid sick leave each year. Employees must be permitted to use paid sick leave for their own illness, injury or other health-related needs, including preventive care; to assist a family member (or person who is like family to the employee) who is ill, injured, or has other health-related needs, including preventive care; or for reasons resulting from, or to assist a family member (or person who is like family to the employee) who is a victim of, domestic violence, sexual assault, or stalking. Additional information on contractor requirements and worker protections under the EO is available at <https://www.dol.gov/agencies/whd/government-contracts>.

Unlisted classifications needed for work not included within the scope of the classifications listed may be added after award only as provided in the labor standards contract clauses (29CFR 5.5 (a) (1) (ii)).

-----  
The body of each wage determination lists the classification and wage rates that have been found to be prevailing for the cited type(s) of construction in the area covered by the wage determination. The classifications are listed in alphabetical order of ""identifiers"" that indicate whether the particular rate is a union rate (current union negotiated rate for local), a survey rate (weighted average rate) or a union average rate (weighted union average rate).

#### Union Rate Identifiers

A four letter classification abbreviation identifier enclosed in dotted lines beginning with characters other than ""SU"" or ""UAVG"" denotes that the union classification and rate were prevailing for that classification in the survey. Example: PLUM0198-005 07/01/2014. PLUM is an abbreviation identifier of the union which prevailed in the survey for this classification, which in this example would be Plumbers. 0198 indicates the local union number or district council number where applicable, i.e., Plumbers Local 0198. The next number, 005 in the example, is an internal number used in processing the wage determination. 07/01/2014 is the effective date of the

most current negotiated rate, which in this example is July 1, 2014.

Union prevailing wage rates are updated to reflect all rate changes in the collective bargaining agreement (CBA) governing this classification and rate.

#### Survey Rate Identifiers

Classifications listed under the "SU" identifier indicate that no one rate prevailed for this classification in the survey and the published rate is derived by computing a weighted average rate based on all the rates reported in the survey for that classification. As this weighted average rate includes all rates reported in the survey, it may include both union and non-union rates. Example: SULA2012-007 5/13/2014. SU indicates the rates are survey rates based on a weighted average calculation of rates and are not majority rates. LA indicates the State of Louisiana. 2012 is the year of survey on which these classifications and rates are based. The next number, 007 in the example, is an internal number used in producing the wage determination. 5/13/2014 indicates the survey completion date for the classifications and rates under that identifier.

Survey wage rates are not updated and remain in effect until a new survey is conducted.

#### Union Average Rate Identifiers

Classification(s) listed under the UAVG identifier indicate that no single majority rate prevailed for those classifications; however, 100% of the data reported for the classifications was union data. EXAMPLE: UAVG-OH-0010 08/29/2014. UAVG indicates that the rate is a weighted union average rate. OH indicates the state. The next number, 0010 in the example, is an internal number used in producing the wage determination. 08/29/2014 indicates the survey completion date for the classifications and rates under that identifier.

A UAVG rate will be updated once a year, usually in January of each year, to reflect a weighted average of the current negotiated/CBA rate of the union locals from which the rate is based.

---

#### WAGE DETERMINATION APPEALS PROCESS

1.) Has there been an initial decision in the matter? This can be:

- \* an existing published wage determination
- \* a survey underlying a wage determination
- \* a Wage and Hour Division letter setting forth a position on a wage determination matter
- \* a conformance (additional classification and rate) ruling

On survey related matters, initial contact, including requests for summaries of surveys, should be with the Wage and Hour National Office because National Office has responsibility for the Davis-Bacon survey program. If the response from this initial contact is not satisfactory, then the process described in 2.) and 3.) should be followed.

With regard to any other matter not yet ripe for the formal process described here, initial contact should be with the Branch of Construction Wage Determinations. Write to:

Branch of Construction Wage Determinations  
Wage and Hour Division  
U.S. Department of Labor  
200 Constitution Avenue, N.W.  
Washington, DC 20210

2.) If the answer to the question in 1.) is yes, then an interested party (those affected by the action) can request review and reconsideration from the Wage and Hour Administrator (See 29 CFR Part 1.8 and 29 CFR Part 7). Write to:

Wage and Hour Administrator  
U.S. Department of Labor  
200 Constitution Avenue, N.W.  
Washington, DC 20210

The request should be accompanied by a full statement of the interested party's position and by any information (wage payment data, project description, area practice material, etc.) that the requestor considers relevant to the issue.

3.) If the decision of the Administrator is not favorable, an interested party may appeal directly to the Administrative Review Board (formerly the Wage Appeals Board). Write to:

Administrative Review Board  
U.S. Department of Labor  
200 Constitution Avenue, N.W.  
Washington, DC 20210

4.) All decisions by the Administrative Review Board are final.

=====

END OF GENERAL DECISIO"

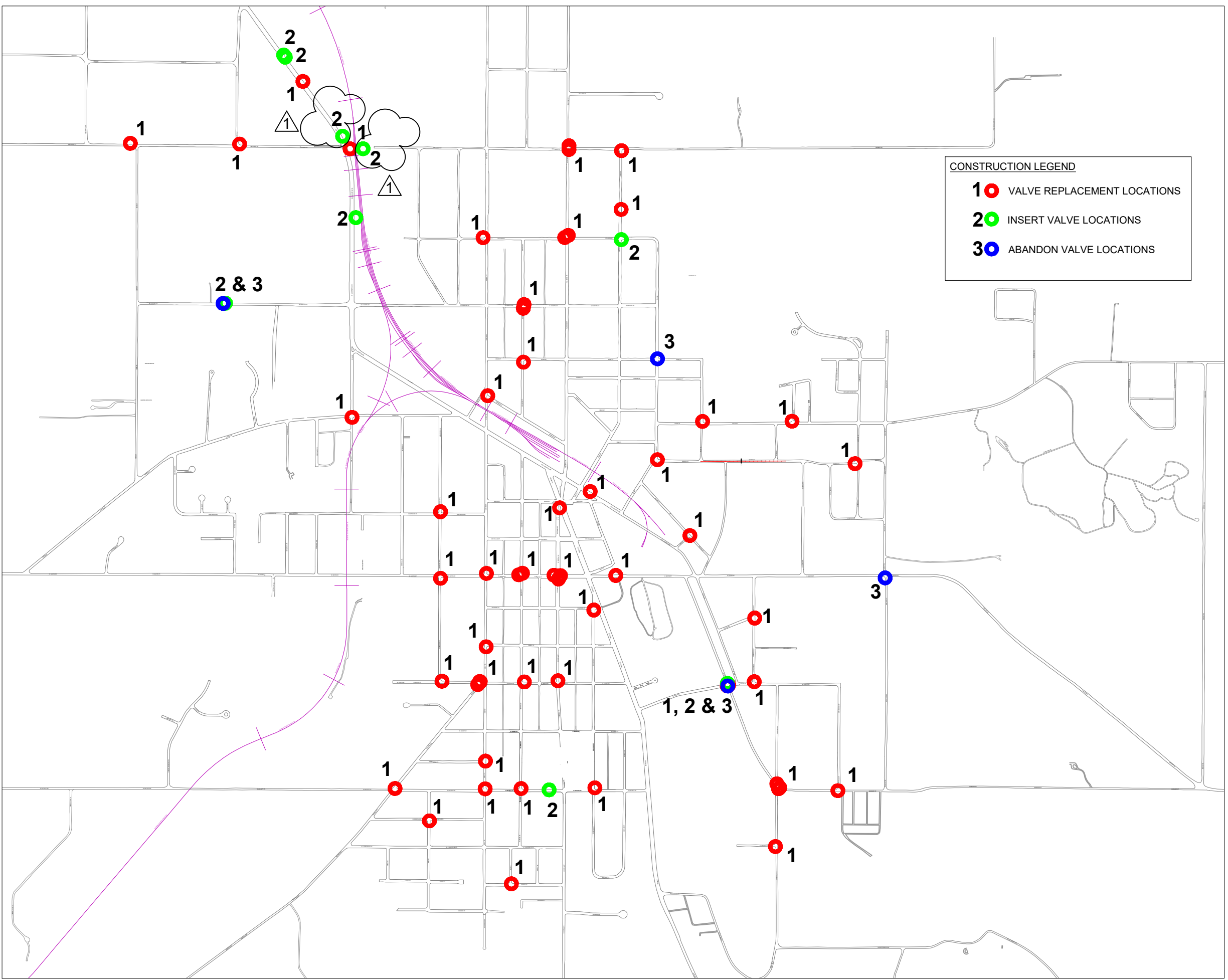

**CONSTRUCTION LEGEND**

- 1** ● VALVE REPLACEMENT LOCATIONS
- 2** ● INSERT VALVE LOCATIONS
- 3** ● ABANDON VALVE LOCATIONS

45 MONROE ST.  
HILLSDALE, MI 49242

REVISIONS	DATE
ISSUED FOR BIDS	2/10/23
ADDENDUM 1	3/06/23

**CITY OF HILLSDALE  
HILLSDALE, MI  
CITY WIDE  
WATER MAIN IMPROVEMENTS  
WATER VALVE WORK LOCATIONS**

SCALE NTS

	NAME	DATE
DESIGNED	KLB	12/29/22
DRAWN	RK	01/06/23
CHECKED	JG	01/13/23

DRAWING NO.  
**WL**

Goodrich / Rea

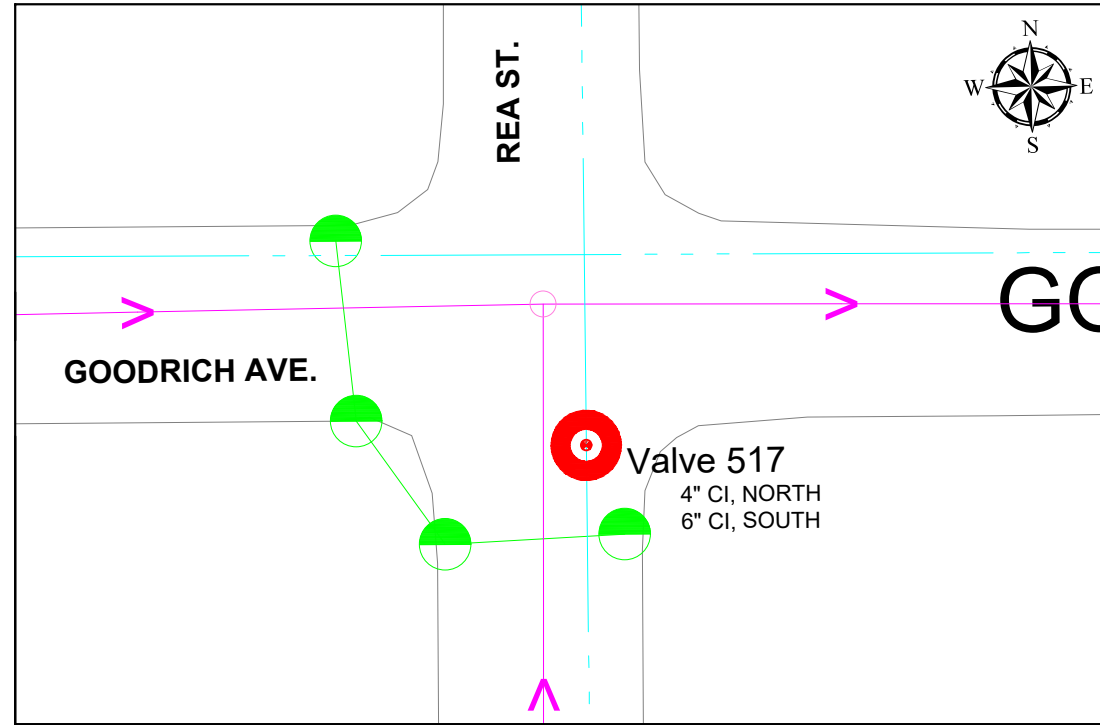

Mechanic / W Carleton

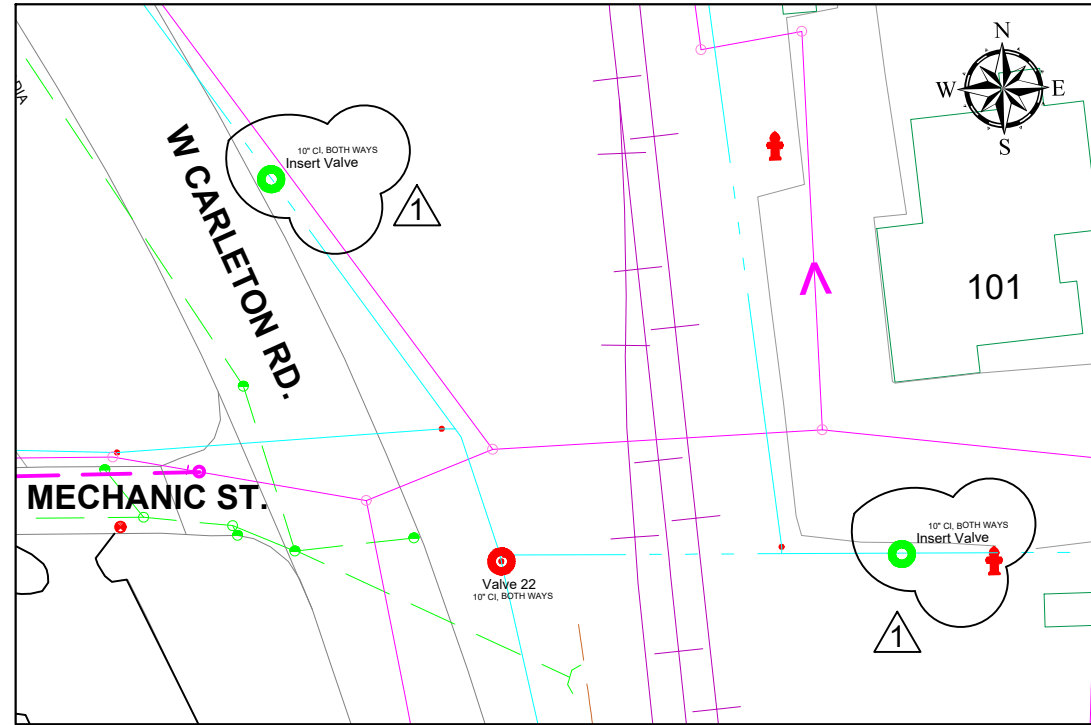

Morry / Elm

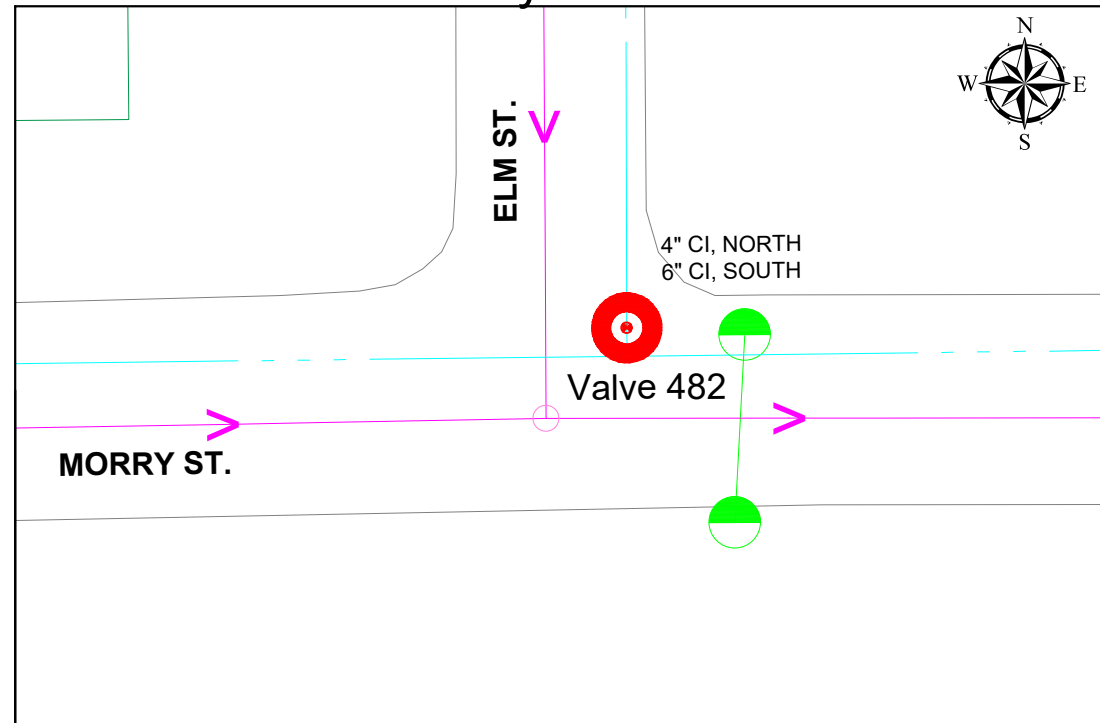

Lopresto / Griswold



KEY		
SANITARY		VALVE REPLACEMENT LOCATION
WATER		VALVE INSERT LOCATION
STORM		VALVE ABANDON LOCATION

REFER TO **W15** FOR TYPICAL CONSTRUCTION DETAILS AND **W16** FOR TRAFFIC CONTROL TYPICALS

45 MONROE ST.  
HILLSDALE, MI 49242

REVISIONS	DATE
ISSUED FOR BIDS	2/10/23
ADDENDUM 1	3/06/23

CITY OF HILLSDALE  
HILLSDALE, MI  
CITY WIDE  
WATER VALVE REPLACEMENTS  
VALVES 22, 336, 482, 517

DRAWING SCALE:  
NOT TO SCALE

DESIGNED	KLB	12/29/22
DRAWN	RK	01/06/23
CHECKED	JG	01/13/23

DRAWING NO. **W9**